

INFORMATION & DATA ON THE FAMILY OF:

VARNAL & HANNAH DOOLITTLE

1814-

1818-1850

---

Being a collection of information from Public records, biographies, histories and family sources, and arranged to present a coherent view of said family and their individual relationship. This has all been done for the purpose of preserving for future generations a knowledge of their past.

Date 18 July 1986

*Edward C. Bartlett*, Compiler

MID-CONTINENT PUBLIC LIBRARY  
NORTH INDEPENDENCE BRANCH  
GENEALOGY DEPT.

## DOOLITTLE

Surname

FAMILY INFORMATION CHART NO. \_\_\_\_\_

Husband's full name Vernal DOOLITTLE  
 born on ca. 1814 at \_\_\_\_\_, New York  
 married \_\_\_\_\_ at \_\_\_\_\_  
 died on between 1873 & 1880 at \_\_\_\_\_  
 interred at \_\_\_\_\_ . Groom's 1st marriage  
Farmer  
 Occupation Religion Military Service  
William DOOLITTLE . Hannah  
 His Father Mother's maiden name

Authority or Source of Data:

Records, Census &amp; Others:

Wife's maiden name Hannah  
 born on 31 Jan. 1818 at \_\_\_\_\_, Pennsylvania  
 died on 2 Aug. 1850 at Crawford County, Illinois  
 interred at Belair, Ills., Cemetery . Bride's \_\_\_\_\_ marriage  
 Her Father Mother's maiden name

Abodes and removals :

Sex	Their Children	Additional Information:
	(1) Name <u>Lutellus DOOLITTLE</u> born on <u>9 Sept. 1839</u> at <u>Licking County, Ohio</u> died on _____ at _____ married _____ at _____ to: _____	Lutellus came with his parents to Crawford Co., Ills., in 1848. In 1865 he went to Montana with Jacob Hart and became engaged in farming and mining there. See biography, page 1285, Meager County, History of Montana, 1739-1885, Pub. 1885.
	(2) Name <u>Lewis (Uncle Lue) DOOLITTLE</u> born on <u>1840</u> at <u>Licking County, Ohio</u> died on <u>14 Mch. 1919</u> at <u>Crescent, Logan Co., OK</u> married <u>never did</u> at _____ to: _____	Lewis enlisted in Capt. Henry Pearce Company, C, Eleventh Regiment of Kansas Cavalry, 11 Aug. 1862 and was discharged 7 Aug. 1865 at Fort Riley, Kansas. In 1889 he made the race into Oklahoma and homesteaded on a farm 3 miles east of Crescent.
	(3) Name <u>Alvira DOOLITTLE</u> born on <u>4 Sept. 1842</u> at <u>Licking County, Ohio</u> died on <u>14 May 1926</u> at <u>East Bernard, Texas</u> married <u>3 Sept. 1861</u> at <u>Washington County, Iowa</u> to: <u>Samuel Thomas MARLING</u> <u>30 May 1840 - 25 Dec. 1925</u>	Children: Milton LeRoy, b. 22 Aug. 1862; Alvin Josiah, b. 27 Nov. 1867; Lewis Edward, b. 23 Feb. 1870; Charles Franklin, b. 16 Mch. 1872 & d. 14 Sept. 1873; Florence Alvira, b. 14 June 1874. M.R., Vol. E, page 9

List other children on the reverse side.

Form B-0285

Sex

( 4 ) Name Almon DOOLITTLE  
 born on 4 Oct. 1844 at Licking County, Ohio  
 died on 22 July 1916 at Crescent, Oklahoma  
 married 31 Aug. 1873 at Crawford Co., Illinois  
 to: Mary Elliott LINGAFELTER  
6 Oct. 1850 - 14 May 1923

Children:

Charles, b. 18 Sept. 1875; Margaret D., b. 28 Mch. 1878; Henry Harrison (Harry), b. 25 Sept. 1879; Nellie Mae, b. 7 June 1880.

( 5 ) Name Albert DOOLITTLE  
 born on ca. 1848 at Licking County, Ohio  
 died on \_\_\_\_\_ at Crawford Co., Illinois  
 married \_\_\_\_\_ at \_\_\_\_\_  
 to: \_\_\_\_\_

Albert served in Company H, 152nd Illinois Infantry - 11 Feb. 1865 to 11 Sept. 1865. He has only a Govt. stone, w/o dates, at his grave in the Bellair cemetery to the south of the village of Bellair, Illinois.

( ) Name \_\_\_\_\_  
 born on \_\_\_\_\_ at \_\_\_\_\_  
 died on \_\_\_\_\_ at \_\_\_\_\_  
 married \_\_\_\_\_ at \_\_\_\_\_  
 to: \_\_\_\_\_

( ) Name \_\_\_\_\_  
 born on \_\_\_\_\_ at \_\_\_\_\_  
 died on \_\_\_\_\_ at \_\_\_\_\_  
 married \_\_\_\_\_ at \_\_\_\_\_  
 to: \_\_\_\_\_

( ) Name \_\_\_\_\_  
 born on \_\_\_\_\_ at \_\_\_\_\_  
 died on \_\_\_\_\_ at \_\_\_\_\_  
 married \_\_\_\_\_ at \_\_\_\_\_  
 to: \_\_\_\_\_

( ) Name \_\_\_\_\_  
 born on \_\_\_\_\_ at \_\_\_\_\_  
 died on \_\_\_\_\_ at \_\_\_\_\_  
 married \_\_\_\_\_ at \_\_\_\_\_  
 to: \_\_\_\_\_

Use this side of another of these forms if there are more than nine children.

This chart was prepared by Edw<sup>d</sup> Bartlett, 7-18-1986







# HISTORY OF MONTANA.

1739-1885.

A HISTORY OF ITS DISCOVERY AND SETTLEMENT, SOCIAL AND COMMERCIAL PROGRESS,  
MINES AND MINERS, AGRICULTURE AND STOCK-GROWING,  
CHURCHES, SCHOOLS AND SOCIETIES,

INDIANS AND INDIAN WARS,

VIGILANTES, COURTS OF JUSTICE, NEWSPAPER PRESS, NAVIGATION, RAILROADS AND STATISTICS,

WITH HISTORIES OF

COUNTIES, CITIES, VILLAGES AND MINING CAMPS;

31156

ALSO,

PERSONAL REMINISCENCES OF GREAT HISTORIC VALUE; VIEWS CHARACTERISTIC  
OF THE TERRITORY IN OUR OWN TIMES, AND PORTRAITS OF  
PIONEERS AND REPRESENTATIVE MEN IN THE  
PROFESSIONS AND TRADES.

ILLUSTRATED.

CHICAGO:  
WARNER, BEERS & COMPANY,  
1885.

COPY PROVIDED BY THE HISTORICAL  
SOCIETY OF MONTANA LIBRARY.

DATE

4-30-74

local schools of England up to the age of nine years, when he came to America, landing in New York, and traveled through to Mineral Point, Wis., living with his father there until 1866. Coming west to Alder gulch in June of the same year, he drove mules across the mountains for his passage; left Alder gulch, the day after his arrival, for Last Chance gulch, and worked there eleven months for wages; bought a blacksmith shop in New York gulch, and operated it until 1872; stayed and grew rich at the place, and as it got poorer he did the same; moved from there to Lower Cave gulch, and fared the same there, or if anything a little worse; left this place in 1877 to work for the United States government as quartermaster's blacksmith at Fort Logan. In September, 1883, he came over to Reedsfort and bought a ranch of 100 acres of Major Reed. The improvements at the place consisted of two log houses and a small log stable; since then he has improved the ranch, fenced the principal part, and built up the present improvements. The ranch is situated on the Martinsdale and Fort Maginnis stage road, and is one of the principal stage stations on the route.

ALFRED O. DE LORIMER, of firm Baker & De Lorimer, Fort Benton, was born May 16, 1852, in Montreal, Canada. At the age of seventeen he clerked in a dry goods store at that point, and in 1870 went to Chicago, where he was salesman for Tuohy Brothers, seven years, coming to Fort Benton, April 29, 1879. He was employed by T. O. Power & Brother, two years, having charge of the dry goods department; then formed a partnership with W. S. Baker and opened a dry goods store corner of St. John and Bond streets. This is the only exclusive dry goods house in Fort Benton. Mr. De Lorimer's present P. O. address is White Sulphur Springs.

MOSES DOGGERT, Canton, son of James S. and Hannah Doggett, was born September 19, 1829, near Louisville, Ky., and moved into Indiana when about seven years of age. In June, 1847, he took up his residence in Iowa, and from 1859 until 1862 was engaged in mining in Colorado. Returning to Iowa, he removed to Montana in 1863, arriving at Horse Prairie Creek, August 2, with his family. He mined on Grasshopper Creek and at Alder Gulch (Virginia City), where he built the first finished house on Idaho street. His son, Jefferson Doggett, was the first white child born in Virginia City, his birth occurring October 29, 1863. When the little one was nine days old, Mrs. Doggett made the trip up the gulch, four miles, to her husband, on an Indian pony, taking the baby and another child on behind her. From January to October Mr. Doggett took out \$14,000 from "No. 29," in Huguland district, Alder Gulch, and selling out and removing to Last Chance Gulch (Helena), purchased two claims in Dry Gulch, below discovery, from which he took \$1,500 in twelve days. In the fall of 1865 he located at what is now Canton, Meagher Co., having then but three neighbors, the nearest residing four miles away. He took a squatter's right and engaged in the stock business and dairying, his market being Diamond City. His ranch now consists of about 900 acres. He constructed the first irrigating ditch from the Missouri valley, and raised a crop in 1866. Mr. Doggett has been twice married, first on the 29th of August, 1849, and second, September 9, 1859. By his first marriage he has two children, Duane and Lafayette; and by the second, seven: Charles B., Jefferson, James, Loren, Ida Montana, Robert, and Lily Mabel. His second wife was Susan Rose, daughter of Lion and Sarah Rose, of Ottumwa, Ia.

LUTELLS DOOLITTLE, of Licking Co., O., was born September 9, 1839; came to Montana with Jacob Hart in 1865, and has since been engaged in farming and mining. In 1872 he visited his home in Illinois, and

returned to Montana in 1873. He owns the farm Mr. Hart resides upon, comprising 280 acres of excellent hay land. Its cost was about \$5,000. He also owns seventy inches of water right.

DUNHAM & MALONEY, White Sulphur Springs. J. W. Dunham, of Dunham & Maloney, White Sulphur Springs, was born September 2, 1834, in Springfield, O., and moved with his parents to Proble Co., in that State, in 1839. He learned the carpenter's trade, which he followed in Ohio, Iowa, and Kansas. In 1859 he went to Colorado and California, sight seeing, returning the same year to Indiana. In 1860 he entered the Colorado mines, and in 1863 engaged in a mine at Alder Gulch, Montana. In 1865 he went to Last Chance (now Helena), and after making several changes, finally located, in 1878, at White Sulphur Springs, where he engaged in his present business together with ranching and raising horses. He is a member of the Masonic order. P. H. Maloney was born in 1844, in Ireland; came to Quebec, Canada, in 1845, with his parents, where his father was engaged as a stone mason. He left his home in 1858 and was employed as a sailor on the lakes, for five years. From 1863 to 1865 he was a passenger brakeman on the Louisville and Nashville Railroad. He was then employed as a watchman on the U. S. Mail steamer "Gen. Lyle," on its route from Louisville to Cincinnati, until 1860, when he came by steamer to Fort Benton, Mont., and engaged in mining at Diamond City, where he later served one term as under sheriff. In 1881 he formed the partnership now existing with Mr. Dunham, and devotes some time to horse raising. He is a member of the I. O. O. F.

JAMES FERGUS, P. O. Fort Maginnis, was born near Glasgow, Scotland, October 8, 1818. Upon reaching early manhood he came to the United States in 1833, settling in the Black Hawk purchase, now the State of Iowa, and was one of the earliest pioneers west of the Mississippi river. Soon after he went to Illinois and built powder mills and had charge of the manufacture of powder for two years. He then removed to Moline, Ill., and engaged in the foundry business there and at Rock Island, with General N. B. Buford, remaining eight years. He was also interested in paper mills. He went subsequently to Minnesota and located at St. Anthony's Falls, then to Little Falls, and laid out that town in 1857. The company under his supervision built the dam and a bridge across the river. He and Jos. Whitford owned the land where Fergus Falls is now located. Whitford was killed in the massacre by the Indians and the property was jumped, but the town was given Mr. Fergus' name which it still bears. In 1860 Mr. Fergus went to Colorado and the following year returned for his family. He found Capt. J. L. Fisk was coming out with an expedition, so he left his family and came with Captain Fisk by the northern route. They were three months on the way, reaching Bannack City in 1862, and engaged in mining. The following spring they went to Virginia City during the great Alder Gulch excitement, and Mr. Fergus was selected the first Recorder of that famous mining camp. He continued mining and prospecting in that vicinity until 1865, when he moved to Last Chance and remained one year. He then engaged in stock-raising and dairy business in the Prickly Pear Valley for some years, then moved to Prickly Pear canyon, where he continued in stock-raising and keeping stallion for ten years. He finally sold out there and removed to his present location on Arnel creek, north of the Judith mountains, where he is engaged in raising cattle, horses and sheep, also farming. Mr. Fergus has been actively identified with the interests of Montana, and is well known throughout the Territory. He was the first Commissioner of Madison county, and held the same position in Lewis and Clarke county six years, and was twice elected to



ELEVENTH REG'T KANSAS VOLUNTEERS - CAVALRY  
COMPANY C

Names and rank	Residence	Date of enlistment	Date of Muster	Remarks
Captain				
Preston B. Plumb	Emporia	---	Sept 10 '62	Pro Maj Sept 25 '62
Lemuel T Heritage	"		Sept 25 '62	Res on account of disability Sept 7 '63 w'n'd in knee in act'n Dec 2 '62 Prairie Grove Mus out w/co Aug 7 '65
Henry Pearce	"		Sept 19 '62	Mustered out w/co Aug 7 '65
First Lieut.				
Henry Pearce	"		Sept 10 '62	Pro Capt Sept 19 '63
Privates				
Doolittle, Lewis	"		Aug 18 '62	Mustered out w/co Aug 7 '65

\*\*\*\*\*

KANSAS VOLUNTEER ORGANIZATIONS

Organization	Date of Muster in	Place of Muster in	Date of Muster out	Place of Muster out
11th Reg Cav	Sept 15 1862	Ft. Leavenworth	Aug 19 1865 Sept 26 1865	Ft. Leavenworth

\*\*\*\*\*

ELEVENTH REGIMENT CAVALRY

Casualties in Kansas regts during the war	Killed		Died of wo'nds		Death by disease		De-serted		Disch for disabil'y		Dis h.rably		Officers cashiered	Officers resigned	Mis ing Officers
	Officers	Enl men	Officers	Enl men	Officers	Enl men	Officers	Enl men	Officers	Enl men	Officers	Enl men			
Company C	-	2	-	2	-	4	-	1	1	16	-	-	-	-	-

Bentley

Lower level

Ref.  
978.1  
C762

HISTORY OF  
**K A N S A S**  
STATE AND PEOPLE

KANSAS AT THE FIRST QUARTER POST  
OF THE TWENTIETH CENTURY

---

WRITTEN AND COMPILED BY

**WILLIAM E. CONNELLEY**

*Secretary of the Kansas State Historical Society,  
Topeka*

---

KANSAS BIOGRAPHY

*By Special Staff of Writers*

---

ILLUSTRATED

---

ISSUED IN FIVE VOLUMES

VOLUME II

---

THE AMERICAN HISTORICAL SOCIETY, INC.

CHICAGO NEW YORK

1928

to Alton, Illinois, to have charge of the military prison there.

The Tenth was at St. Louis from May until August, 1864, where it served as provost guard of that city.

From St. Louis the regiment was sent to Fort Leavenworth, where it was discharged.

The Tenth Kansas Veteran Regiment was made up of four companies, as shown in the report of the Adjutant-General. Two companies, F and I, were recruited, and were named Companies A and B. The veteran regiment was commanded by Major H. H. Williams from its organization until the last of August, 1864. It was then sent to Pilot Knob, Missouri, Major Williams having been detailed to command Schofield Barracks at St. Louis.

On the 7th of November, the regiment embarked at St. Louis for Paducah, Kentucky. On the 28th of November, it arrived at Nashville, and on the 29th it arrived at Columbia, Tennessee. Here it was assigned to the Fourth Army Corps.

After the battle of Franklin, it fell back with General Schofield's army and was stationed at Nashville until the 16th of December.

In the assault on Hood's position at Nashville, the Tenth was deployed as skirmishers in advance of the Second Brigade, where it drove back the rebel skirmish line and silenced a battery.

It was also in the action on the 16th and 17th, and in the pursuit of the rebels when they retreated.

The veterans saw much service in the South during the winter of 1864. It was at Eastport, Miss., Waterloo, Ala., and at Vicksburg. At Vicksburg the regiment was transferred to New Orleans and camped at Chalmette until the 7th of March. On the 7th it embarked for the Mobile expedition, stopping at Fort Gaines and camping on Dauphin Island at the entrance to Mobile Bay.

On the 20th it went up the Bay to the mouth of Fish River, and later went into camp at Donnelly's Mills. It was in the siege which followed, and was deployed as skirmishers in front of the entire brigade. Mobile was evacuated on the 11th, and the Union soldiers took possession on the 12th. On the following day, the Tenth marched for Montgomery, Alabama, where it arrived on the 25th. It remained at Montgomery, with headquarters at Greenville, until the following August, doing provost duty. It was mustered out at Montgomery the last of September, when it was sent to Fort Leavenworth for final discharge.

The Tenth saw much hard service, and was one of the good regiments in the Union forces during the war.

#### ELEVENTH KANSAS VOLUNTEER CAVALRY

President Lincoln issued the call on July 2, 1862, for additional troops. Under the call, the Kansas quota was three regiments of infantry. Gen. James H. Lane was authorized by the War Department to recruit these troops. He empowered Thomas Ewing, Jr., then Chief Justice of the Kansas Supreme Court, to raise one of the regiments. The regiment so raised by General Ewing was the Eleventh Kansas Infantry, afterwards changed to Cavalry. Following is the field and staff:

Names and rank	Date of muster	Remarks
<i>Colonel</i>		Pro. Brig. Gen. U. S. Vol. Mar.
Thomas Ewing, Jr.	Sept. 15, '62	13, '63.
Thomas Moonlight	Apr. 25, '64	Mus. out July 17, '66, Ft. Kearny, N. T.

*Lieut. Colonel*

Thomas Moonlight -----Sept. 29, '62---Pro. Col. Apr. 25, '64.  
 Preston B. Plumb-----May 17, '64---Mus. out Sept. 13, '65, Ft. Leav.

*Major*

Preston B. Plumb-----Sept. 25, '62---Pro. Lieut. Col. May 17, '64.  
 Martin Anderson -----Nov. 22, '63---Mus. out Sep. 18, '65, Ft. Leav.;  
 pro. Col. by brevet Mar. 13,  
 '65.

Edmund G. Ross-----Apr. 24, '64---Mus. out Sep. 20, '65, Ft. Leav.;  
 pro. Lieut. Col. by brevet Mar.  
 13, '65.

Nathaniel A. Adams---May 19, '64---Mus. out Aug. 9, '65.

*Adjutant*

John Willans -----Sept. 4, '62---Pro. Capt. and Asst. Adj. Gen.  
 U. S. Vol. May 31, '63.

James E. Greer-----Nov. 2, '63---Pro. Capt. Co. I, Aug. 20, '64.

Ira I. Taber-----Oct. 12, '64---Mus. out Aug. 19, '65.

*Quartermaster*

James R. McClure-----Sept. 10, '62---Mus. out Aug. 10, '65.

*Commissary*

Robert J. Harper -----Oct. 8, '63---Mus. out Aug. 18, '65.

*Surgeon*

George W. Hogeboom---Sept. 27, '62---Resigned June 2, '63.

Richard M. Ainsworth---June 23, '63---Dismissed by order of President,  
 July 21, '65.

*Asst. Surgeon*

Richard M. Ainsworth---Sept. 20, '62---Pro. Surgeon, June 23, '63.

Josiah D. Adams-----Oct. 11, '62---Mus. out Sep. 20, '65.

Granville C. Taylor---Apr. 19, '64---Mus. out Aug. 19, '65.

*Chaplain*

James S. Cline-----Oct. 11, '62---Mus. out July 7, '65.

The service of the Eleventh Kansas has been noted to a large extent in the body of this work. That portion which has not been mentioned consisted of the service in Wyoming. In February, 1865, most of the regiment was assembled at Fort Riley, from which point it marched to Fort Kearny, Nebraska. This was one of the hardest marches of the war. There were heavy storms of snow and sleet, and the soldiers suffered intensely from the cold. The march was made, however, in twelve days.

On the 7th of March, the regiment started for Fort Laramie. This was also a terrible march. How the men survived it is a mystery. At the Sioux Agency, thirty miles below Fort Laramie, a halt was made to wait further instructions. After a short stop the regiment went on to Fort Laramie and then to Platte Bridge. Here headquarters were established, and the work of protecting the telegraph line over the Oregon Trail commenced. The Indians were also held in check. It was found that the ammunition forwarded from Fort Leavenworth was not suitable for the carbines carried by the Eleventh, and there was a great delay in getting suitable ammunition. Colonel Plumb was assigned the duty of protecting the Overland Stage Line from Camp Collins, Colorado, to Green River, nearly four hundred miles. He was given command of Companies A, B, F, L, and M. This service Colonel Plumb performed to the satisfaction of the Stage Company and of the Government. He re-established the service and maintained it.

The remainder of the regiment at Platte Bridge was attacked by thousands of Sioux Indians on the 22nd of July. Major Martin Anderson was in command of Platte Bridge, and fought the battle of that name. It was a heroic engagement, many accounts of which may be found in histories of those times.

The regiment was mustered out at Fort Leavenworth in September, 1865.

#### TWELFTH KANSAS VOLUNTEER INFANTRY

The Twelfth Kansas Infantry was mustered in at Paola, September 25, 1862, under the following field and staff:

Names and rank	Date of muster	Remarks
<i>Colonel</i>		
Charles W. Adams	Sept. 30, '62	Pro. Brev. Brig. Gen. Feb. 13, '65; wounded in action, Apr. 30, '64, Jenkin's Ferry, Ark.; mus. out with reg. June 30, '65.
<i>Lieut. Colonel</i>		
Josiah E. Hayes	Sept. 30, '64	Pro. Brev. Brig. Gen.; wounded in action and captured by enemy, Apr. 30, '64, Jenkin's Ferry, Ark.; limb amputated above the knee; exchanged Feb. 25, '65; mus. out July 15, '65.
<i>Major</i>		
Thomas H. Kennedy	Sept. 30, '62	Mus. out with reg. June 30, '65.
<i>Adjutant</i>		
Charles J. Lovejoy	Sept. 30, '62	Res. Apr. 28, '65, Little Rock.
<i>Quartermaster</i>		
Andrew J. Shannon	Sept. 30, '62	Pro. Capt. and Asst. Pro. Marshal Mar. —, '64.
Joshua Clayton	May 22, '64	Mus. out with reg. June 30, '65.
<i>Surgeon</i>		
Cyrus R. Stuckslager	Sept. 30, '62	Mus. out with reg. June 30, '65; capt'd by the enemy, Apr. 30, '64, Jenkin's Ferry, Ark.; exchanged June 28, '64.
<i>Asst. Surgeon</i>		
Thomas Lindsay	Sept. 30, '62	Mus. out with reg. June 30, '65.
John F. Everhart	Sept. 30, '62	Resigned Nov. 4, '63.
<i>Chaplain</i>		
Werter R. Davis	Sept. 30, '62	Resigned Jan. 26, '64.
William Sellers	Mar. 26, '64	Resigned Apr. 12, '65.

The Twelfth Kansas, upon its muster into the service, was scattered along the border to hunt guerrillas and bushwhackers, and to protect the State from bands of these Ruffians.

In the winter of 1863, most of the regiment was at Fort Smith. From that point it did escort duty. In February the different parts of the regiment were reunited at Fort Smith. On the 23rd of March the regiment left Fort Smith, and on the 9th of April, joined General Steele's command, which arrived at Camden, Arkansas, on the 16th, remaining until the 26th. It was in the battle of Jenkin's Ferry, after which it returned to Fort Smith by way of Little Rock, reaching the

whom it may concern



Know Ye, That Lewis G. White  
Henry Pearce

was enrolled on the Eighth  
to serve THREE YEARS, in  
this month day of August

of Expiration of term of service  
(No objection to his being recruited is known to exist.)\*

Said Lewis G. White  
State of Ohio

high school  
a Chamber

Given at Fort Riley, Kansas this Seventh day of August 1863

\*This sentence will be erased should there be any thing in the conduct or physical condition of the soldier rendering him unfit for the Army.

Henry Pearce  
Capt. Co. C. 117th Regt.

Company (B.) Eleventh  
Regiment of Kansas Cavalry who  
on the eighth hundred and sixty-  
fourth day of August in the service of the United States,  
at Fort Riley Kansas by reason



was born in Spring Co. in the  
year of age, 5 feet 6 inches

day of August 1863

W. B. Johnson  
Capt. Co. C. 117th Regt.

ACT OF MAY 11, 1912.  
AMENDED BY ACT, MARCH 4, 1913.

No 632,828

Reissue and  
Increase



**BUREAU OF PENSIONS**

It is hereby certified That, in conformity with the laws of the

United States Lewis Doolittle  
who was a Private, Co. C, 11<sup>th</sup> Regiment Kansas Cavalry

is entitled to a pension at the rate of  
Twenty-four dollars per month from May 21, 1912,  
and Thirty dollars per month from February 28, 1917.  
dollars per month from

Reissue to correct rate and allow Increase

Given at the Department of the Interior, this

tenth day of May

one thousand nine hundred and fifteen  
and of the Independence of the United States  
of America the one hundred and thirty-ninth

*[Handwritten signature]*

Secretary of the Interior

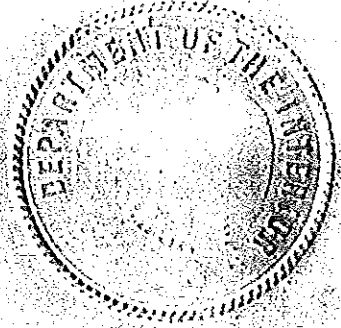

Countersigned

*[Handwritten signature]*

Commissioner of Pensions

*[Handwritten initials]*

Former payments covering any portion of the same time to be deducted.

No. 632, 828

PENSION CERTIFICATE OF

Lewis Doolittle

Payable Quarterly

by the

Disbursing Clerk,  
Bureau of Pensions.

Group 2

( Former Agency, Topeka. )

F. M. H.  
Clerk.

That section forty seven hundred and forty five, title fifty seven of the Revised Statutes of the United States is hereby amended to read as follows:  
Sec. 4745.—Any pledge, mortgage, sale assignment, or transfer of any right, claim, or interest in any pension which has been, or may hereafter be granted, shall be void and of no effect, and any person who shall pledge or receive as a pledge, mortgage, sale assignment or transfer of any right, claim, or interest in any pension or certificate which has been, or may hereafter be granted or issued or who shall hold the same as collateral security for any debt or promise, or upon any pretext of such security, or promise, shall be guilty of a misdemeanor, and upon conviction thereof shall be fined in a sum not exceeding one hundred dollars and the costs of the prosecution, and upon conviction thereof shall be punished as a felon, or a United States pension agent, or any other person authorized by the Commissioner of Pensions of Pensions, or the pensioner, to receive the same shall be guilty of a misdemeanor, and upon conviction thereof shall be fined in a sum not exceeding one hundred dollars and the costs of the prosecution.

Approved February 28, 1889.



## CHAPTER LXX

### INDIAN LAND CESSIONS AND ADDITIONAL LAND OPENINGS

During the spring of 1890, the members of the commission to treat with the Cherokee Nation and other tribes and nations of Indians, for the relinquishment of unoccupied lands situated west of the Ninety-sixth Meridian, spent much time in negotiating with the Iowa, the Sac and Fox, the Pottawatomie and the Absentee Shawnee, and the Kickapoo tribes. In May, of that year, General Fairchild resigned his membership on the commission and former governor George W. Jerome, of Michigan was appointed to fill the vacancy thus created. In June following, negotiations were opened with the Cheyenne and Arapaho tribes. As the result of the work of this commission, all of the tribes above mentioned, with the exception of the Kickapoo, agreed to accept allotments of land in severalty and permit the opening of the surplus lands of their respective reservations to settlement by white people.

#### OPENING OF THE FIRST INDIAN RESERVATIONS

The first of the surplus lands thus thrown open to settlement were those of the Iowa, Sac and Fox, and Pottawatomie-Shawnee reservations, all of which were located east of the country which had been thrown open to settlement in April, 1889. The aggregate area of these reservations was 868,414 acres and the date set for their opening to homestead settlement was September 22, 1891. From the lands thus opened to settlement, two new counties were formed, in addition to which Logan, Oklahoma and Cleveland counties were enlarged by the addition of lands lying east of the Indian Meridian and the area of Payne County was increased by the addition of that part lying south of the Cimarron River. One of the new counties was officially designated as County "A" and the other as County "B." In the general election of the following year (November, 1892), the people of these counties by popular

PROMINENT NORTH LOGAN  
RESIDENT IS DEAD

—+—  
"Uncle Lue" Doolittle Came To  
Oklahoma and Logan County  
In '89; Civil War Veteran  
and a Splendid Citizen

---

Lewis Doolittle, a well to do retired farmer of Cresent, died Friday March 14 of heart trouble. He is an uncle of Margaret and Nettie Doolittle of Guthrie.

Mr. Doolittle was 79 years of age, a veteran of the Civil war, having served for three years in the 157th Kansas Infantry. He was an '89'er having made the race into Oklahoma and homesteading a farm three miles east of Cresent.

"Uncle Lue" as he was familiarly known to both young and aged, was a kind and highly respected citizen. He was never married. He leaves to mourn his loss a sister, Mrs. S. T. Marling of East Bernard, Texas, a brother in Montana, and the family of his deceased brother, Mrs. Mary Doolittle and daughters, Margaret and Nettie.

---

GUTHRIE DAILY LEADER, March 17, 1919,  
page 1, column 2. e.e.b., 1986

**BULLETIN.**  
**Peking, March 17.**—The Chinese government is alarmed over a report coming from Petrograd relative to the formation of a Chinese workmen's organization with a city thousand members, for the object of carrying on revolutionary propaganda and establishing Soviets in China. Inquiries are being made by the authorities as to measures which will effectually check such activities.

**TO EXECUTE ALL WHO FIGHT AGAINST GOVERNMENT**

**Copenhagen, March 17.**—Orders issued by Minister of War Noske, for the execution of persons possessing arms and fighting against the government have been withdrawn, according to a Berlin dispatch received here.

**YANKS REFUSE TO FIGHT WITH YELLOW BOYS**

**London, March 17.**—The test question for the German delegates at the peace conference will be the "west bank of the Rhine," says a Berlin dispatch to the Mail. The delegates will be authorized to break negotiations if the matter is forced upon them and in this case the cabinet will support the delegation and will resign if the national assembly takes a different attitude.

**WEST BANK OF THE RHINE IS IN QUESTION**

**London, March 17.**—A private wireless dispatch from Tokyo says: "Evidence of allied disunion in Siberia following news of Japanese reverses is contained in reports which have confirmed on inquiry at authoritative quarters. General O's command includes small American forces at Harbin, which were unwilling to aid the Japanese against the enemy in recent encounters. These Americans are described in Tokyo papers as pro-Bolshevists."

and turned the weapon on the fleeing Germans when the 27th (New York) division pressed forward into the place, was told here today by Major Triestram Tupper, division adjutant.

When the fighting had ceased the body of the aged woman was found beside the machine gun. The Germans had returned to shoot and stab the grand dame who had done her bit for France.

**PROMINENT NORTH LOGAN**

**RESIDENT IS DEAD**

**"Uncle Lue" Doolittle Came To Oklahoma and Logan County In '89; Civil War Veteran and a Splendid Citizen**

Lewis Doolittle, a well-to-do retired farmer of Crescent, died Friday, March 11, of heart trouble. He is an uncle of Margaret and Nettie Doolittle of Guthrie.

Mr. Doolittle was 79 years of age, a veteran of the Civil war, having served for three years in the 14th Kansas Infantry. He was an "sober" having made the race into Oklahoma and homesteaded a farm three miles east of Crescent.

"Uncle Lue" as he was familiarly known to both young and old, was a kind and highly respected citizen. He was never married. He leaves to mourn his loss a sister, Mrs. S. T. Marling of East Bernard, Texas, a brother in Montana, and the family of his deceased brother, Mrs. Mary Doolittle and daughters, Margaret and Nettie.

**COCHRELL CROWDED MUCH INTO YEARS SERVICE**

Some May

Tex the world, Willard jun retirement's showing love

**Tide Is**

Guthrie business They are all ed business Laboring people are drawing in before. Prices higher but so people are star Farmers, also than ever before And furthermore crop of fruit in sight. Therefore, it circulate. "We The tide has Dismiss all net try is going to employment hard A period of ep The problem soon for jobs rather

MARLING

Surname

FAMILY INFORMATION CHART NO. \_\_\_\_\_

Husband's full name Samuel Thomas MARLING  
 born on 30 May 1840 at Marion County, Ohio  
 married 3 Sept. 1861 at Washington County, Iowa<sup>1</sup>  
 died on 25 Dec. 1925 at East Bernard, Texas  
 intered at E. Bernard Methodist Cem.. Groom's 1st marriage  
Farmer 7th Day Adventist Co.'G', 22nd Iowa Vol Inf  
 Occupation Religion Military Service  
John MARLING Hannah C. WARDEN  
 His Father Mother's maiden name

Authority or Source of Data:

Robert W. Evans  
 401 Bellaire  
 Waco, Texas 76710 (1986)

Records, Census & Others:

1. Washington Co., IA, Marriage  
 Records, Book E, page 9.

Wife's maiden name Alvira DOOLITTLE  
 born on 4 Sept. 1842 at Licking County, Ohio  
 died on 14 May 1926 at \_\_\_\_\_  
 intered at E. Bernard Methodist Cem.. Bride's 1st marriage  
Vernal DOOLITTLE Hannah  
 Her Father Mother's maiden name

Abodes and removals :

Sex	Their Children	Additional Information:
	(1) Name <u>Milton LeRoy MARLING</u> born on <u>22 Aug. 1862</u> at <u>Washington County, Iowa</u> died on <u>17 Dec. 1937</u> at <u>East Bernard, Texas</u> married <u>21 Sept. 1889</u> at <u>Winfield, Cowley Co., KS</u> to: <u>Dora Elizabeth GRAHAM</u>	
	(2) Name <u>Alvin Josiah MARLING</u> born on <u>27 Nov. 1867</u> at <u>Sarcoxie, Jasper Co., MO</u> died on <u>22 Aug. 1945</u> at <u>Ralston, Oklahoma</u> married <u>9 Apr. 1892</u> at <u>New Salem, Cowley Co., KS</u> to: <u>Ruth Ellen GRAHAM</u>	
	(3) Name <u>Lewis Edward MARLING</u> born on <u>23 Feb. 1870</u> at <u>Sarcoxie, Jasper Co., MO</u> died on <u>29 Sept. 1949</u> at <u>Santa Barbara, California</u> married _____ <u>1893</u> at <u>Winfield, Kansas</u> to: <u>#1. Mabel Lee TOMLINSON</u>	

List other children on the reverse side.





Stephen Potts, Ass't Marshal

1850 CENSUS — UNITED STATES

State OHIO County GUERNSEY Township CAMBRIDGE DIST. 46 Roll No. 684

Page	Dwelling Number	Family Number	Names	Age	Sex	Color	Occupation, etc.	Value - Real Estate	Birthplace	Married within year	School within year	Cannot read or write	Enumeration Date	Remarks
290	2088	2100	Thomas OLDEHAM	38	M		Farmer	1500	O				4th Oct.	
			Eliza "	42	F				Pa.					
			Jonathan T. "	8	M				O	1				
			Francis W. "	6	M				"					
	2089	2101	Marling OLDEHAM	30	"		Farmer	1600	"					
			Isabella "	28	F				Va.					
			Elizabeth "	8	"				O	1				
			Ellen "	2	"				"					
			Josiah MARLING	15	M		Farmer		"		1			
	2091	2103	Daniel MARLING	35	M		Farmer	400	"					
			Margaret "	26	F				"					
			Matthew "	1	M				"					
295	2158	2170	Isaac MARLING	39	"		Farmer	350	Va.				7th Oct.	
			Minerva "	38	F				Pa.					
			John "	14	M				O		1			
			Sarah "	12	F				"		1			
			Samuel "	10	M				"		1			
			Rachel S. "	3	F				"					

Transcribed from film by Edw. Bartlett, Jan. 3, 1986

1850 CENSUS — UNITED STATES  
 GUERNSEY

Roll No. 684  
 888 No. 684

See under remarks  
 Township

County

OHIO

Page	Dwelling Number	Family Number	Names	Age	Sex	Color	Occupation, etc.	Value - Real Estate	Birthplace	Married within year	School within year	Cannot read or write	Enumeration Date	Remarks
295	219	241	John MARLING	68	M		Farmer	2500	Pa.				7th Oct.	CAMBRIDGE TWP. Stephen Potts, Ass't Marshal
			Esther "	64	F				"					
			Samuel MARLING	36	M		Farmer	(nl)	O					
			Amelia "	34	F				O					
			Sarah "	9	"				"		1			
			Rachael "	7	"				"		1			
			Esther "	5	"				"					
			Austin "	3	M				"					
384	48	48	John MARLING	38	M		Farmer	(nl)	Ohio				18th July	ADAMS TWP. C. L. Madison, Ass't Marshal
			Hanna C. "	37	F				"			1		
			Jno. "	13	M				"					
			James O. "	11	"				"		1			
			Saml T. "	9	"				"		1			
			Aaron A. "	7	"				"		1			
			Harriet A. "	3	F				"					
			Maria I. "	1	"				"					
426	605	606	Thos. MARLING	29	M		Farmer	2000	Ohio				15th Aug.	JEFFERSON TWP. C. L. Madison Ass't Marshal
			Mary J. "	26	F				"					
			Jno. "	7	M				"					

nl = none listed



W. B Bolding, Ass't Marshal

1860 CENSUS -- UNITED STATES

IOWA State IOWA County WASHINGTON Township IOWA P.O. YATTON RICHMOND & YATTON Roll No. 344

Page	Dwelling No.	Family No.	Names	Age	Sex	Color	Occupation, etc.	Value - Real Estate	Value - Personal Property	Birthplace	Married In Year	School In Year	Can't Read or Write	Enumeration Date	Remarks
106	803	787	Isaac MARLING	49	M		Farmer		290	(not legible)				20th July	
107			Manerva MARLING	48	F				150	Pa.					
			John Q. "	25	M		Farmer			Ohio					
			Samuel "	20	M					"					
			Rachel "	12	F					"		1			
110	826	809	John MARLIN (sic)	48	M		Farmer	1900	886	Ohio				21st July	
			Hannah "	47	F					"					
			James O "	22	M					"					
			Samuel T "	19	"					"					
			Aaron A. "	17	"					"					
<p>Isaac &amp; John Marling and families were in Cambridge Township of Guernsey County, Ohio, for the 1850 Federal Population Census. (pages 295 &amp; 384) Notice that John &amp; Hannah's daughters, Harriet &amp; Maria, recorded in the Guernsey County Census of 1850 were not recorded in this 1860 census.</p>															
<p>Transcribed from film by Edw Bartlett, Jan. 9, 1986</p>															



MARLING BURIALS  
IN THE  
PROTESTANT CEMETERY  
Riverside, Iowa

ISAAC MARLING

DIED

Jan. 2, 1890

AGED

78 Yrs, 9 Ms,  
22 Ds

(south side)

MINERVA

WIFE OF

ISAAC MARLING

DIED

FEB. 23, 1870

AGED 58 Yrs,  
1 Mo, 9 Ds

JOHN Q.

SON OF

I. & M. MARLING

DIED

Oct. 19, 1862

AGED 27 Yrs,  
8 Ms, 14 Ds

MARLING

(west side)

MINERVA

WIFE OF

ISAAC MARLING

DIED

Feb. 23, 1870

AGED

58 Ys, 1 Mo, 9 Ds

J. Q. MARLING

DIED

OCT. 19, 1862

AGED

27 Yrs, 8 Ms,  
14 Ds

Visited 21 Sept. 1987  
e. e. b.

MID-CONTINENT PUBLIC LIBRARY  
NORTH INDEPENDENCE BRANCH  
GENEALOGY DEPT.



DOOLITTLE  
Surname  
FAMILY INFORMATION CHART NO. \_\_\_\_\_

<p>Husband's full name <u>Almon DOOLITTLE</u>          born at <u>Licking County, Ohio</u> on <u>4 Oct. 1844</u>          married at <u>Crawford Co., Illinois</u> on <u>31 Aug. 1873 (1)</u>          died at <u>Logan Co., Oklahoma</u> on <u>22 July 1916</u>          interred at _____ No. Groom's marriages <u>1</u></p> <p>Farmer          Occupation _____ Religion _____ Military Service _____  <u>Vernal DOOLITTLE</u> _____ <u>Hannah</u>          His Father _____ Mother's maiden name _____</p> <p>Wife's maiden name <u>Mary Elliott LINGAFELTER</u>          born at <u>Licking County, Ohio</u> on <u>6 Oct. 1850</u>          died at <u>Harrisonville, Missouri</u> on <u>14 May 1923</u>          interred at _____ No. Bride's marriages <u>1</u></p> <p style="text-align: center;">Cumberland Presbyterian</p> <p>Occupation _____ Religion _____  <u>William LINGAFELTER</u> _____ <u>Margaret RILEY</u>          Her Father _____ Mother's maiden name _____</p> <p>Abodes and removals: Came from Ohio with parents in 1848 to Crawford Co., Ills.. Came to Cowley Co., Kansas in 1883. In 1891 left to homestead in Logan Co., Oklahoma.</p>	<p>Authority or source of information:          Mrs. James A. Graves, II (Ola)          P. O. Box 263          Shell Knob, MO 65747</p> <p>Records, Census &amp; Others:          (1) Crawford Co. Marriage Record "B", page 301          Dr. Arthur Graves &amp; wife, Nellie's obituaries in the Cass County Democrat - Missourian, Harrisonville, MO</p>															
<table border="1" style="width: 100%; border-collapse: collapse;"> <thead> <tr> <th style="width: 10%;">Sex</th> <th style="width: 50%;">Children</th> <th style="width: 40%;">Additional information</th> </tr> </thead> <tbody> <tr> <td></td> <td>                     (1) Name <u>Charles DOOLITTLE (2)</u>                      born at <u>Crawford Co., Ills.</u> on <u>18 Sept. 1875</u>                      died at <u>Crawford Co., Ills.</u> on <u>20 Sept. 1875</u>                      married at _____ on _____                      to _____                 </td> <td>                     (2) Charly is buried in the Belaire, Ills. Cemetery. The date of his death is from his gravestone and gives his age as 2 days.                 </td> </tr> <tr> <td></td> <td>                     (2) Name <u>Margaret D. DOOLITTLE (3)</u>                      born at <u>Crawford Co., Ills.</u> on <u>28 Mar. 1878*</u>                      died at <u>Durant, Oklahoma</u> on <u>16 Mar. 1969</u>                      married at _____ on _____                      to <u>W. S. GREGORY (4)</u> </td> <td>                     (3) Was Supt. of Public Education, Logan Co., Guthrie, Okla., 1919 - per letter to S.T. Marling, E. Bernard, TX                      (4) Taught govt. in college in Durant, OK, until his death.                 </td> </tr> <tr> <td></td> <td>                     (3) Name <u>Henry Harrison (Harry) DOOLITTLE</u>                      born at <u>Crawford Co., Ills.</u> on <u>25 Sept. 1879</u>                      died at <u>Osborne, Kansas</u> on <u>31 Dec. 1962</u>                      married at <u>Osborne, Kansas</u> on <u>25 May 1902</u>                      to <u>Cardell (NMN) HENSLEY</u>                      b. 22 Aug. 1876 - d. 29 June 1922                 </td> <td>                     Children                      1. Harry Alvey DOOLITTLE                      b. 2 Feb. 1908, Osborne Co.                      2. Jessie Helen DOOLITTLE                      b. 7 Jan. 1910, Osborne Co.                      3. Joy (nmn) DOOLITTLE                      b. 11 Oct. 1913, Osborne Co.                 </td> </tr> <tr> <td></td> <td>                     (4) Name <u>Nellie Mae DOOLITTLE</u>                      born at <u>Crawford Co., Ills.</u> on <u>8 June 1882 (6)</u>                      died at <u>Harrisonville, MO</u> on <u>17 Sept. 1971</u>                      married at <u>Oklahoma City, OK</u> on <u>28 May 1908</u>                      to <u>Dr. James Arthur GRAVES (7)</u>                      List other children on the reverse side.                 </td> <td>                     Had one son:                      Arthur Jean GRAVES                      b. 1 Feb. 1919                      w. Kansas City, Missouri                      (6) Birth Records, Vol. 1, pg. 182.                      (7) b. 3/29/1883, Shenandoah, IA                      d. 8/15/1973, Harrisonville, MO                 </td> </tr> </tbody> </table>	Sex	Children	Additional information		(1) Name <u>Charles DOOLITTLE (2)</u> born at <u>Crawford Co., Ills.</u> on <u>18 Sept. 1875</u> died at <u>Crawford Co., Ills.</u> on <u>20 Sept. 1875</u> married at _____ on _____ to _____	(2) Charly is buried in the Belaire, Ills. Cemetery. The date of his death is from his gravestone and gives his age as 2 days.		(2) Name <u>Margaret D. DOOLITTLE (3)</u> born at <u>Crawford Co., Ills.</u> on <u>28 Mar. 1878*</u> died at <u>Durant, Oklahoma</u> on <u>16 Mar. 1969</u> married at _____ on _____ to <u>W. S. GREGORY (4)</u>	(3) Was Supt. of Public Education, Logan Co., Guthrie, Okla., 1919 - per letter to S.T. Marling, E. Bernard, TX (4) Taught govt. in college in Durant, OK, until his death.		(3) Name <u>Henry Harrison (Harry) DOOLITTLE</u> born at <u>Crawford Co., Ills.</u> on <u>25 Sept. 1879</u> died at <u>Osborne, Kansas</u> on <u>31 Dec. 1962</u> married at <u>Osborne, Kansas</u> on <u>25 May 1902</u> to <u>Cardell (NMN) HENSLEY</u> b. 22 Aug. 1876 - d. 29 June 1922	Children 1. Harry Alvey DOOLITTLE b. 2 Feb. 1908, Osborne Co. 2. Jessie Helen DOOLITTLE b. 7 Jan. 1910, Osborne Co. 3. Joy (nmn) DOOLITTLE b. 11 Oct. 1913, Osborne Co.		(4) Name <u>Nellie Mae DOOLITTLE</u> born at <u>Crawford Co., Ills.</u> on <u>8 June 1882 (6)</u> died at <u>Harrisonville, MO</u> on <u>17 Sept. 1971</u> married at <u>Oklahoma City, OK</u> on <u>28 May 1908</u> to <u>Dr. James Arthur GRAVES (7)</u> List other children on the reverse side.	Had one son: Arthur Jean GRAVES b. 1 Feb. 1919 w. Kansas City, Missouri (6) Birth Records, Vol. 1, pg. 182. (7) b. 3/29/1883, Shenandoah, IA d. 8/15/1973, Harrisonville, MO	
Sex	Children	Additional information														
	(1) Name <u>Charles DOOLITTLE (2)</u> born at <u>Crawford Co., Ills.</u> on <u>18 Sept. 1875</u> died at <u>Crawford Co., Ills.</u> on <u>20 Sept. 1875</u> married at _____ on _____ to _____	(2) Charly is buried in the Belaire, Ills. Cemetery. The date of his death is from his gravestone and gives his age as 2 days.														
	(2) Name <u>Margaret D. DOOLITTLE (3)</u> born at <u>Crawford Co., Ills.</u> on <u>28 Mar. 1878*</u> died at <u>Durant, Oklahoma</u> on <u>16 Mar. 1969</u> married at _____ on _____ to <u>W. S. GREGORY (4)</u>	(3) Was Supt. of Public Education, Logan Co., Guthrie, Okla., 1919 - per letter to S.T. Marling, E. Bernard, TX (4) Taught govt. in college in Durant, OK, until his death.														
	(3) Name <u>Henry Harrison (Harry) DOOLITTLE</u> born at <u>Crawford Co., Ills.</u> on <u>25 Sept. 1879</u> died at <u>Osborne, Kansas</u> on <u>31 Dec. 1962</u> married at <u>Osborne, Kansas</u> on <u>25 May 1902</u> to <u>Cardell (NMN) HENSLEY</u> b. 22 Aug. 1876 - d. 29 June 1922	Children 1. Harry Alvey DOOLITTLE b. 2 Feb. 1908, Osborne Co. 2. Jessie Helen DOOLITTLE b. 7 Jan. 1910, Osborne Co. 3. Joy (nmn) DOOLITTLE b. 11 Oct. 1913, Osborne Co.														
	(4) Name <u>Nellie Mae DOOLITTLE</u> born at <u>Crawford Co., Ills.</u> on <u>8 June 1882 (6)</u> died at <u>Harrisonville, MO</u> on <u>17 Sept. 1971</u> married at <u>Oklahoma City, OK</u> on <u>28 May 1908</u> to <u>Dr. James Arthur GRAVES (7)</u> List other children on the reverse side.	Had one son: Arthur Jean GRAVES b. 1 Feb. 1919 w. Kansas City, Missouri (6) Birth Records, Vol. 1, pg. 182. (7) b. 3/29/1883, Shenandoah, IA d. 8/15/1973, Harrisonville, MO														

Other information & sources: \* Funeral record gives Margaret's date of birth as Mar. 28, 1882, age 86 but the 1880 Fed Census has recorded her as being 2 yrs. old. Form B-0280 Thus she was about 91 at time of death. Rev. 1, 2-3-84

State Illinois County Peoria 1880 CENSUS - UNITED STATES Mc. J. Vance, Exumerton 20.  
 Township Licking Roll No. 183

Page	Dwelling No.	Family No.	Names	Color	Sex	Age prior to June 1st	Month of birth if born in census yr	Relationship to head of house	Single	Married	Widowed	Divorced	Married in census year	Occupation	Miscellaneous Information	Cannot read or write	Place of birth	Place of birth of father	Place of birth of mother	Enumeration Date
17	153/154		Doakittle, Almon	W	M	35			1					Farmer			Ohio	Ny		9 6 10 <sup>th</sup> June
			Mary (1)	W	F	28		wife	1					Keeping house			Ohio			
			Margaret	W	F	2		Daughter	1								Illinois	Ohio	Ohio	
			Harry	W	M	2		son	1								Illinois	Ohio	Ohio	
17	154/155		Doakittle, Wilson	W	M	57			1					Farmer			New York	Vt.	Vt.	
			Amelia	W	F	55		wife	1					Keeping house			Ohio	Vt.	Vt.	
			James	W	M	32		son	1					Farmer			Illinois	Ny	Ohio	
			Nettie	W	F	16		Daughter	1					at home	attended school		Illinois	Ny	Ohio	
			George	W	M	11		son	1					at home	attended school		Illinois	Ny	Ohio	
			Charles	W	M	8		son	1						" "		Illinois	Ny	Ohio	

(1) Mary Kinggabetter married 31 Aug 1873. Married to Almon 11/7/82.





1910 CENSUS

Microfilm 1260  
Roll No.

State OKLAHOMA

Township/Town CITY OF GUTHRIE

Supt. Dist. No. 1 Sheet No. 3 A

County LOGAN

Daniel M. Lentz, Enumerator date 19th April

Enum. Dist. No. 125 Line No.

LOCATION	NAME	PERSONAL DESCRIPTION				NATIVITY			CITIZEN.		OCCUPATION				EDUC.			HOME			Blind both eyes					
		Sex	Age	No. of years of present marriage	Number born	Number living	Place of birth	Place of father	Place of mother	Year of immigration	Naturalized / Alien	Speaks English or other	Trade or Profession	Nature of work	Employer, employee	Out of work Apr 15	Weeks out of work '09	Can read	Can write	Attended school		Home owned or rented	Free or mortgaged	Farm or house	No. of farm enns.	
623 House No.	of each person whose place of abode on April 15, 1910 was in this family	M	40	19		Geor- Gia	Geor- Gia	Geor- Gia			Eng	Con- ductor	Rail Road	M	no	0	Yes	Yes		✓	✓	H				
44 Dwelling No.	CLARK, John A.	M	36	19		Flor- ida	Geor- gia	Geor- gia			Eng	None					Yes	Yes								
46 Family No.	Sarah E.	M	18	1*	1*	Flor- ida	Geor- Gia	Flor- ida			Eng	None					Yes	Yes	Yes							
	Elmer C.	M	29	1*		Illi- nois	Ohio	Ohio			Eng	Asst Sup erintend ent Schools	County	M			Yes	Yes	Yes							
	DOOLITTLE, Maggie	M	22			Kansas	Ohio	Ohio			Eng	Teacher	Public School	M			Yes	Yes	Yes							
	Nettie	M																								
	* sic																									
	Transcribed, 8-14-86 e.e.b.																									

Street North Vine Street



My great Grandfather Doolittle's name was William

His children were.

1. Vernal Doolittle {
  - Lutellus
  - Lewis
  - Alvira - married Sam Marling.
  - Almon - married Mary Ringafelter. Margan Harry Nettie
  - Albert - died young.
  - Shannon - ~~deceased~~
  - Alva married Barber Dawson died Barber
2. Wilson Doolittle {
  - Jim
  - Nettie
  - Charlie.
  - Millie Postelwaite 
  - Alvira Hart
  - William Burner
  - Ida
3. Rochester - moved to Story City Iowa.
4. Alvira Doolittle - married Ward.
5. I've forgotten any more.

Who was my grandmother  
Who was Uncle Tom Lewis uncle of your father  
Who was Aunt Millie Doolittle's wife  
Were the Miles Hart related to my father yes  
Were the Thorpe related to my father yes

DOOLITTLE

When this family came to the U.S. from England, their name was spelled Dewlittle - but as time went by in the process of recordings, the spelling was changed to Doolittle. The family were merchants in England and came to the U.S. in the 1700's. The location of the family as known by members of later generation, was at Rochester, New York and the name Rochester was given to decendants -- also the name Sylvester appears on file in Illinois. Some came to Ohio and located near Springfield or Columbus.

The parents Varnel Doolittle (a shoemaker) and Elvira Lewis were married here where their children Luetellis, Lewis, Albert, Alvira, Almon 1844, and Shannon were born (it may be just the older ones). The family came to Illinois about 1848 as an older brother of his fathers; Wilse Doolittle had located near Bellair, Ill., a small town not far from Casey, Ill. About 1858 Varnel Doolittle, wife and six children went overland by wagon to Colby, Kansas, but stayed only a short time and started back to Illinois by wagon. The mother and infant died at Emporia, Kansas, and are buried there. Luetellis and Lewis remained in Emporia. The father and rest of family went to South Missouri near Sarcxie and left Alvira with a sister either of her mothers or fathers (Hart), also one son Albert stayed here, at least no more record of him until his death recorded by the Civil War Dept.

Leutellis and Shannon were in Helena, Montana for several years. In the years between 1902 and 1904, Leutellis visited the Almon Doolittle family in Okla. I remember when I was staying in the Martha Case home when I was cashier at the Cyclone Mercantile Co. in Guthrie, he spent a Sunday with me in the Case home. Later when he died in Montana, Uncle Lew went back there, but the result of that visit is not clear in my mind or if Shannon was still living. (Signed Nellie Doolittle.)

Add anything more you know Margaret. There must have been quite a colony of them in Illinois. As I remember the cementary at Bellair, Ill. was filled at one section of tombstones with Doolittle inscribed.

Luetellis and Lewis joined the P.B. Plum Regiment at Emporia and fought throughout the Civil War. Lewis was in the Lone Jack battle in Cass Co., Missouri and was lost for three days from his regiment. (The date of this battle, August 16th, was for many years observed by residents with a reunion.) Almon and Shanon returned to Illinois with their father and in 1874 Almon was married to Mary Elliot Lingafelter and lived in a log cabin for three or four years. It was still there in 1904, when visited by his daughters Margaret and Nellie.

In late 1883 they came to Burden, Kansas where Almon's sister Alvira lived with her husband Samuel Marling, (a former resident of near Sarcoxie, Mo.) and four children.

At this time, four children had been born to Almon and Mary Doolittle-- Charles who died when he was 2 days old, Margaret, Harry, and Nellie. Another child was born while they lived in Kansas, Nettie Alice. They lived near Burden in Cowley Co., Kansas until February 1891 when they left with their four children by wagon to pioneer a homestead in Logan County Okla. as four counties in Central Indian Territory had been open for settlement. His brother Lewis had made the run at the opening in 1889 and 160 acre homesteaded was across the road from his brother Lewis (a bachelor), 12 miles from Guthrie, the capitol at that time -- until 1911? -- near Crescent, Okla.

The writer of this remembers the long four days drive across Indian Territory (Cherokee Strip), crossing swollen Salt Fork Creek and the dark nights, howling of coyotes and food that was eaten standing up or sitting on the cold ground -- saw no one, not even an Indian -- and as we came to the line of the inhabited Logan County and saw houses made of planks, sod or dugouts, a few cows, horses and occasionally another wagon, it seemed like heaven.

We went about 15 miles south, (the small town of Crescent 4 miles west), when we came to the Lewis Doolittle farm. He had a 3 room house, sort of a chicken house and barn and fenced pasture. Our household goods, machinery, chickens and cows came by car on Santa Fe Railroad, to Lamrie a station about 6 miles east, a second team of horses was led behind our wagon across the Cherokee Strip. Our home was small and a cyclone cellar built and well dug. We first carried water from a spring (a long trip). Here is where the Almon and Mary Doolittle family grew up-- on virgin soil and hard labor.

So during his life, Almon Doolittle made two overland wagon trips. He died in 1916 at his home in Crescent, Okla.

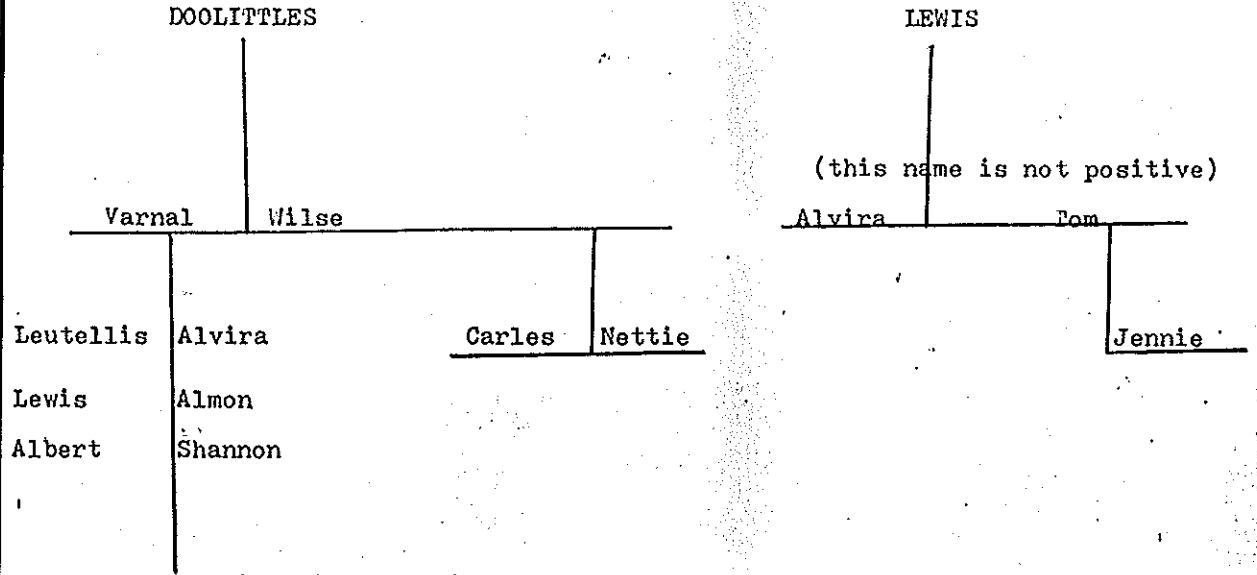

By another marriage in late life Alvin Doolittle was living in Illinois in 1904 or was it 1928 when Arthur Jean Graves and I visited. Seems Mayme Freeland and Aunt Amanda took us to his home.

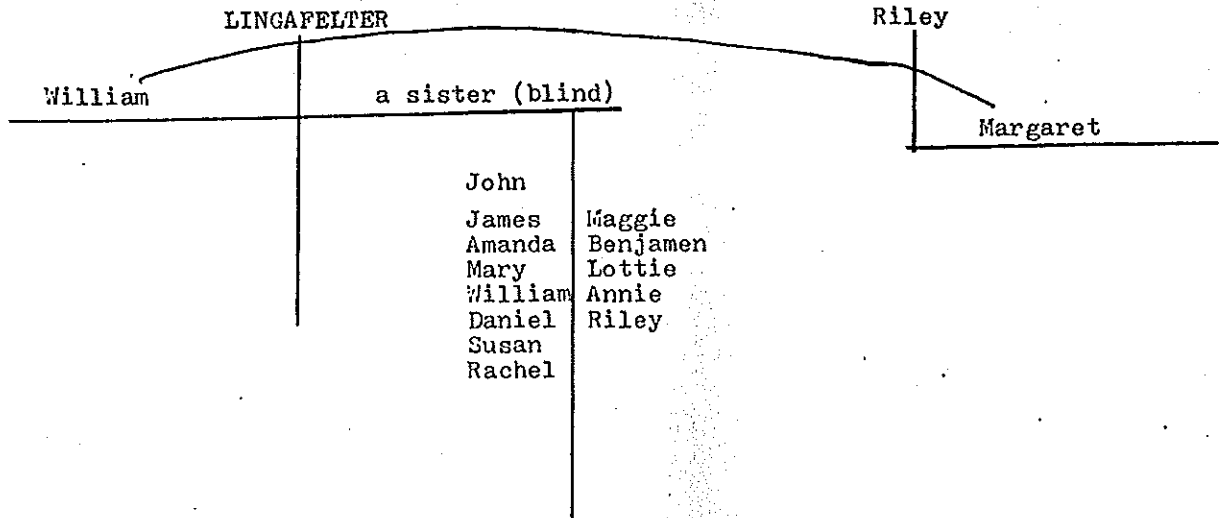

### LINGAFELTERS

Parents of William Lingafelter came to Ohio from Pennsylvanie in the early 1800's. They were of Dutch descent and his mother could not or would not learn to speak English. His father was a keeper (as called then) of a large farm owned by a wealthy family by the name of Elliot.

The Riley's were southern Irish and came to Ohio in the early 1830's, typical southern-- rode hunting and jumping horses and lived high class as reported by (Mary E. Lingafelter). William Lingafelter -- Pen. Dutch and Margaret Riley - Southern Irish, were married in Ohio in the 1840's (Margaret Riley was 16 yrs old when married) and continued to live near Newark, Ohio where they grew up until nine childred were born. In the late summer of 1865 with seven of their children (Amanda and James stayed in Ohio), John, Mary E., William, Daniel, Susan, Maggie and Rachel left in a wagon train of seven wagons for Illinois. They met the Civil War soldiers walking home from their service in the Federal Army. They were six weeks on the way and the mother, Margaret Lingafelter, was not able to sit up when they got to their destination near Martinsville, Illinois. After coming to Illinois, four more children were born, Benjamin, Lottie, Annie and Riley. During the second year in Illinois, Maggie died of Typhoid Fever, and the baby Benny died in his second year, leaving 11 of the 13 children born to them. Amanda came to Illinois in a few years, but James still stayed in Ohio and was connected with a bank in Columbus, Ohio. He was the first of the eleven children to die. There are two still living -- Annie and Riley and numberless descendents.

So during her life, Mary Elliot Lingafelter Doolittle made two overland wagon trips. She died at the home of her daughter, Nellie (Mrs. James Arthur Graves) near harrison, Mo. in 1923, was born in 1850.



State OHIO County LICKING NEWTON Township NEWARK, OHIO P.O. NEWARK, OHIO Roll 999 (Part 2)  
 1860 CENSUS — UNITED STATES (Daniel) A. B. Moore, Ass't Marshal

Page	Dwelling No.	Family No.	Names	Age	Sex	Color	Occupation, etc.	Value - Real Estate	Value - Personal Property	Birthplace	Married in Year	School in Year	Can't Read or Write	Enumeration Date	Remarks
128	278 973 805		John Lingafelter	41	m		Carpenter	1500	500	Penna.				19th July	
			Elizabeth Lingafelter	34	f					Virginia					
			Sarah E. Lingafelter	13	f					Ohio					
			John Lingafelter	10	m					Ohio					
			James A. Lingafelter	1	m					Ohio					
			John P. Hale	8 1/2						do.					
129	979 806		Abraham Lingafelter	63	m		Farmer	3000	300	Virginia					
			Susan Lingafelter	66	f					do.					
	980 807		Daniel Lingafelter	31	m		Farmer	800	700	Penna.					
			Angeline Lingafelter	26	f					Maryland					
			Amelia Lingafelter	6	f					Ohio					
			Julia A. Lingafelter	3	f					do.					
			George A. Lingafelter	8 1/2						do.					
			Henry Riffey *	69	m		Laborer			Virginia					
															Transcribed from film by Edward Bartlett, Jan. 19, 1984
															* 1850 Licking Co. Census, p. 880 - 1684/1696 Henry Riffey, age 57 & family of 7.





Anstin W. Gordon, Ass't Marshal

1870 CENSUS - UNITED STATES

State ILLINOIS County CRAWFORD Town LICKING TWP. P.O. ANNAPOLIS Roll 214  
 Dwelling No. Family No. Names Age Sex Color Occupation, etc. Value - Real Estate Value - Personal Property Birthplace Father born Mother born Foreign born Month born in year Month married in year School in Year Can't Read or Write Eligible to vote Date of Enumeration

Page	Dwelling No.	Family No.	Names	Age	Sex	Color	Occupation, etc.	Value - Real Estate	Value - Personal Property	Birthplace	Father born	Mother born	Foreign born	Month born in year	Month married in year	School in Year	Can't Read or Write	Eligible to vote	Date of Enumeration
22	161	157	LINGAFELTER, William	48	M	W	Farmer			Pennsylvania								1	20th July
			Margaret	42	F	W	Keeping House			Ohio									
			John	25	M	W	Farmer			Ohio								1	
			Amanda	22	F	W	at Home			Ohio									
			Mary	20	F	W	at Home			Ohio									
			Susan	8	F	W				Ohio						1			
23			Daniel	11	M	W				Ohio						1			
/60			Racheal	6	F	W				Ohio						1			
			Charlotte	4	F	W				Ohio									
			Angeline	1	F	W				Ohio									
35			LINGAFELTER, James	40	M	W	Farmer			Pennsylvania								1	21st July
/66	246	241	Charlotte	32	F	W	Keeping house			Ohio									
			Abraham	15	M	W				Illinois						1			
			John W.	11	M	W				Illinois						1			
			James A.	9	M	W				Illinois						1			
			David	7	M	W				Illinois						1			
			Richard	5	M	W				Illinois									
			Willard	2	M	W				Illinois									
			Transcribed, 7-28-86 e.e.b.																

(page Nos. 60 & 66 were printed on the forms.)

Story City Ia July 12"47.

Dear Mrs Gregory"

I am sorry to tell you that I am unable to find out our great grand fathers name,

Wm. Rochester Doolittle was born in Rochester N.Y. April fourth 1824.

It was my Father that visited you in Okla. but it was more than forty years ago as my Father died in 1896.

All of my uncles and aunts have passed on except one of the youngest boys and i think he is seventy five years old.

Seems that if there was any record of the family kept it has been lost.

I am happy to learn that the Doolittles founded Walingford Conn. so long ago, and that they have a reunion every five years.

If you go to the reunion please let me know what you find out about our Great Grandfather and any other information that you may get.

If I am able to find out anything I will let you know.

Hopeing this will do you some good little as it is

I remain your distant Cousin

*Lee Doolittle  
Story City Iowa.*

*Arthur Graves  
"Nettie Butch" Nellie*



GRAVES

Surname

FAMILY INFORMATION CHART NO. \_\_\_\_\_

Husband's full name James Arthur GRAVES, DVM  
 born on 29 Mch. 1883 at Shenandoah, Page County, Iowa  
 married 28 May 1908 at Oklahoma City, Oklahoma  
 died on 15 Aug. 1973 at Harrisonville, Cass Co., MO

Authority/Source of Data:

Ola M. Graves  
 P. O. Box 263  
 Shell Knob, MO 65747

Interred at Orient Cemetery Groom's 1<sup>st</sup> marriage  
 Dr. Vet'y Med. Methodist none  
 Occupation \_\_\_\_\_ Religion \_\_\_\_\_ Military Service \_\_\_\_\_

Records, Census & Others:

Albert S. GRAVES 1. Rhoda GRIEST  
 His father \_\_\_\_\_ Mother's maiden name \_\_\_\_\_

Wife's maiden name Nellie Mae DOOLITTLE  
 born on 7 June 1883 at Crawford County, Illinois  
 died on 17 Sept. 1971 at Harrisonville, Missouri  
 Interred at Orient Cemetery Bride's 1<sup>st</sup> marriage

Almon DOOLITTLE Mary LINGAFELTER  
 Her father 1844-1916: \_\_\_\_\_ Mother's maiden name 1850-1923 \_\_\_\_\_

Abodes and removals:

Sex \_\_\_\_\_

Their Children

Additional Information:

(1) Name Arthur Jean GRAVES  
 born on 1 Feb. 1919 at Kansas City, Missouri  
 died on \_\_\_\_\_ at \_\_\_\_\_  
 married 15 June 1946 at Yuma, Yuma Co., Arizona  
 to: Edith Caroline PRATT  
1919 - 19 Sept. 1960

Children:  
 1. James Arthur GRAVES II 2.  
 b. 4 Dec. 1947  
 w. Monett, Missouri  
 2. Alfred Guy GRAVES  
 b. 3 June 1951  
 d. 3 June 1951

(2) Name \_\_\_\_\_  
 born on \_\_\_\_\_ at \_\_\_\_\_  
 died on \_\_\_\_\_ at \_\_\_\_\_  
 married \_\_\_\_\_ at \_\_\_\_\_  
 to: \_\_\_\_\_

(3) Name \_\_\_\_\_  
 born on \_\_\_\_\_ at \_\_\_\_\_  
 died on \_\_\_\_\_ at \_\_\_\_\_  
 married \_\_\_\_\_ at \_\_\_\_\_  
 to: \_\_\_\_\_

Prepared by  
 Edw<sup>d</sup> Bartlett, 01-19-88

1. & 2. see other side for footnotes.

### Nellie M. Graves

Mrs. Nellie M. Graves, Harrisonville, died Friday, Sept. 17 at her home here.

She was born in Illinois on June 7, 1883 and moved with her parents to Oklahoma when she was nine years old. She was educated there and taught in Oklahoma schools several years.

She married Dr. Arthur Graves on May 28, 1908, in Oklahoma City, Okla., and in 1917 the couple moved to Kansas City. They moved to Harrisonville in 1922 and lived on a farm east of here. They lived at the present East Pearl street home for more than 10 years.

Mrs. Graves is survived by her husband, Dr. Arthur Graves of the home; one son, Dr. Arthur Gean Graves, Mt. Vernon; and one grandson, James Arthur Graves, Chicago, Ill. She was preceded in death by her parents, two sisters and one brother.

She was a member of the Harrisonville United Methodist Church and the Women's Society of Christian Service as well as the Auxiliary I Extension Club.

## Obit

**DR. ARTHUR GRAVES**  
Arthur Graves, doctor of veterinary medicine, Harrisonville, died Wednesday, Aug. 15, at the Cass County Memorial Hospital here.

He was born on March 29, 1883, near Shenandoah, Iowa, the son of Albert and Rhoda Greist Graves.

He moved to Oklahoma at the age of 20 and to Kansas City in 1914. He was a 1917 graduate of the Kansas City Veterinary College.

Dr. Graves was married to Nellie Doolittle in 1908. She preceded him in death in 1971.

Dr. Graves came to Harrisonville in 1922 after five years in government service. He was a member of the Harrisonville United Methodist Church.

He leaves one son, Dr. Arthur G. Graves, Mt. Vernon; one grandson, James Arthur Graves, Chicago, Ill., and a brother, C. E. Graves, Fort Morgan, Colo.

Funeral services were held Saturday, Aug. 18, at the Harrisonville United Methodist Church with Rev. Stephen G. Johnson, Sr., officiating. Burial was at Orient cemetery in Harrisonville.

### DR. ARTHUR GRAVES

Dr. Arthur Graves, Harrisonville, died Wednesday, Aug. 15, at the Cass County Memorial Hospital here.

Dr. Graves was a retired veterinarian.  
Funeral arrangements were not complete at printing time.

THE CASS COUNTY  
DEMOCRAT - MISSOURIAN  
FRIDAY, AUGUST 17, 1973  
Page 3A

Location of the Graves family stones  
in the

ORIENT CEMETERY  
Harrisonville, Missouri

Located on the east part of town. From the courthouse go one block south and turn left (east) on East Mechanic Street (MO 7) follow it east for approximately one mile. Turn right on the road in front of the Dickey Funeral Home and go one half mile. The cemetery is on the left (north) of the road. Turn in at the first entrance then turn right at the first drive and stop. The large upright, stone with GRAVES will be immediately noticeable. The individual's stones are nearly level with the top of the ground.

- |   |  |
|---|--|
| <p>1. <span style="border: 1px solid black; padding: 5px; display: inline-block; width: 100px; height: 20px; text-align: center;">GRAVES</span></p> <p style="margin-left: 20px;">The large stone</p> | <p>4. <span style="border: 1px solid black; padding: 5px; display: inline-block; width: 100px; height: 40px; text-align: center;">EDITH C. PRATT<br/>Wife of Arthur J.<br/>GRAVES<br/>1919 - 1960</span></p> |
| <p>2. <span style="border: 1px solid black; padding: 5px; display: inline-block; width: 100px; height: 20px; text-align: center;">NELLIE GRAVES<br/>1883 - 1971</span></p>                            | <p>5. <span style="border: 1px solid black; padding: 5px; display: inline-block; width: 100px; height: 40px; text-align: center;">ALFRED GUY<br/>GRAVES<br/>May 3, 1951</span></p>                           |
| <p>3. <span style="border: 1px solid black; padding: 5px; display: inline-block; width: 100px; height: 20px; text-align: center;">ARTHUR GRAVES<br/>1883 DVM 1973</span></p>                          |  |

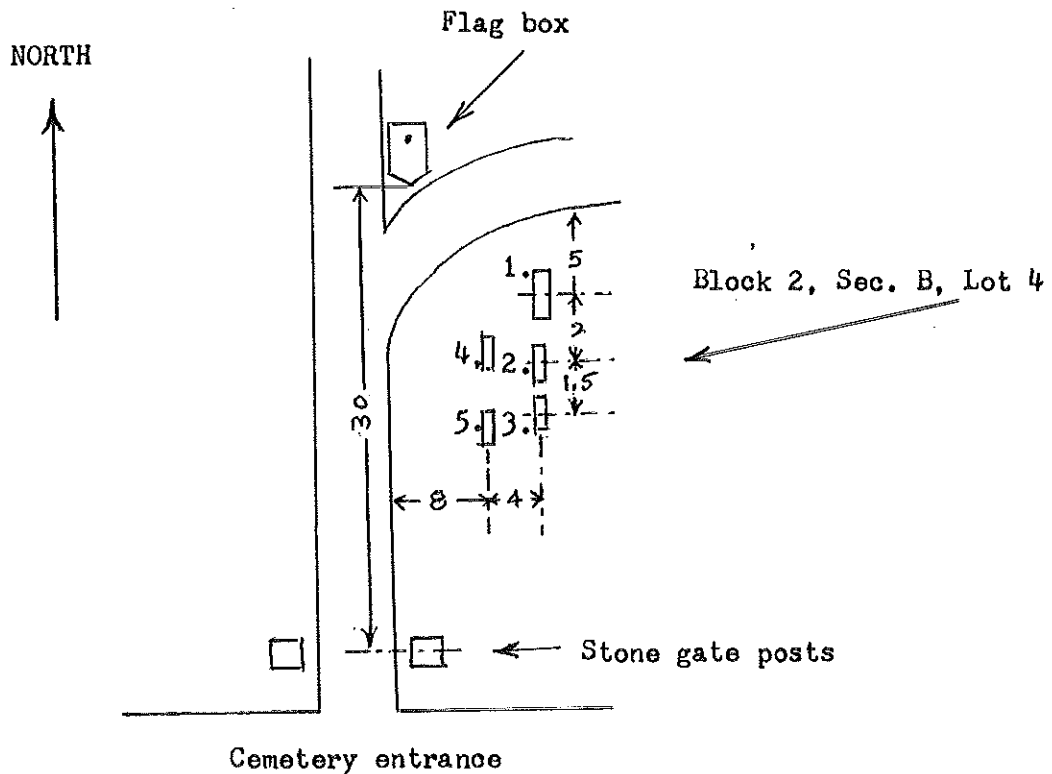

Not drawn to scale. Dimensions are in paces. One pace = 3 feet more or less.  
Edward Bartlett, 23 July 1984

# 'The Ol' Doc' Returns

By Boyce Bowdon

**MARSHALL** — One of Oklahoma's first veterinarians is back home this week observing Marshall's "Prairie City Days."

He is 89-year-old Dr. Arthur Graves, who retired only six years ago after practicing 45 years in Harrisonville, Mo., where he now lives.

Dr. Graves came to Marshall on a freight train in 1903 and remained until 1916, when he joined the Army and did food conservation work in World War I.

Even though they had not seen him in more than half a century, several old-timers recognized Dr. Graves when he appeared this weekend at the worship services of the Marshall Methodist Church, where he once served as Sunday school superintendent.

At a church picnic Sunday afternoon, attended by over 100, Dr. Graves visited with the girl who used to live next door, Miss Angie Debo.

The two swapped stories and caught up on old times.

Since their last visit, Miss Debo has earned a doctor's degree from University of Oklahoma and has written a dozen books. Her historical novel about life of Oklahoma pioneers inspired the annual "Prairie City Days" a week-long festivity featuring a picnic, parade, rodeo and talent show.

Dr. Graves "still remembers every sick horse and cow he ever treated," Miss Angie remarked.

In the early 1900s, one of the first things a Marshall man did when he got up in the morning was rush out to the barn and see if he still had his favorite horse. Horse thieves hit frequently, he said. There was little law enforcement and



Dr. Arthur Graves



Miss Angie Debo

plenty of hiding places in the brush hills.

Hoping to cope with this serious threat, Dr. Graves and other Marshall men organized a chapter of the Anti-Horse Thief Association. To head the organization they elected a tall, tough former U.S. marshal who wore a pair of six-guns and had a reputation for using them. "Just the sight of that formidable character was enough to encourage horse thieves to move on," the old-time vet recalls.

"We would have parades and every time a horse was stolen we would organize a search party. We never did catch any horse thieves, but we sure discouraged a lot of them.

"After a year or so, we didn't have any trouble with rustling."

Rabies broke out in Marshall back in 1915. "A man called me and by the time I got out to see his shepherd, the dog was dead. He had been chained to a tree stump and had dug clear under the roots of the tree, fighting to get loose. All indications were that he had rabies.

"As a result of the dog's infection, one man lost a valuable pair of mares, another lost a horse, and one lost a hog and cow." Several people bitten by suspicious animals had to take shots, but none of

them developed rabies, he added.

"We did a lot of dental work on horses during those days. Eating hard grain wore teeth down and they often had to be evened." Dr. Graves said extracting teeth from young horses was always a tough job.

"There were some features about my work that were not too tasty. I would often come home at night, feeling like I just couldn't go any further, and yet I would know somebody was needing me. People would work a horse hard all day, and he would be sick at night. Then they would wait until bedtime, thinking the animal might get better. When he didn't, they would call Ol' Doc."

It was customary during those days for a veterinarian to charge one dollar the first mile and fifty cents each additional mile for his calls. Dr. Graves says most of his fees ranged from \$2.50 to \$5.

"I'd imagine that there are families around Marshall that still have the hides of their favorite horses that were made into overcoats, mittens, or lap robes," the old vet remarked. Horses were mighty important to us, and we loved them in a way that people can't love cars."

DOOLITTLE

Surname

FAMILY INFORMATION CHART NO. \_\_\_\_\_

Husband's full name Henry Harrison (Harry) DOOLITTLE  
 born on 25 Sept. 1879 at Crawford County, Illinois  
 married 25 May 1902 at Osborne, Kansas  
 died on 31 Dec. 1962 at Osborne, Kansas  
 interred at Osborne, Kansas, Cemetery Groom's 1st marriage

Occupation \_\_\_\_\_ Religion \_\_\_\_\_ Military Service \_\_\_\_\_  
Almon DOOLITTLE . Mary Elliott LINGAFELTER  
 His Father 1844-1916 Mother's maiden name 1850-1923

Wife's maiden name Cardell (nmn) HENSLEY  
 born on 22 Aug. 1876 at Osborne County, Kansas  
 died on 29 June 1922 at Osborne, Kansas  
 interred at Osborne, Kans., Cemetery. Bride's 1st marriage  
George HENSLEY . Helen ALVEY  
 Her Father \_\_\_\_\_ Mother's maiden name \_\_\_\_\_

Abodes and removals :

Authority or Source of Data:

Mrs. Joy Cochrun  
 Box 236  
 Luray, Kansas 67649  
 Courtesy of R. W. Evans

Records, Census & Others:

Harry's birth recorded in the  
 Crawford Co., IL, Register,  
 Vol. LL, page 16.

Sex	Their Children	Additional Information:
	(1) Name <u>Harry Alvey DOOLITTLE</u> born on <u>2 Feb. 1908</u> at <u>Osborne County, Kansas</u> died on <u>3 Feb. 1908</u> at <u>Osborne County, Kansas</u> married _____ at _____ to: _____	Harry Alvey was buried in the Zimmerman cemetery, Osborne County.
	(2) Name <u>Jessie Helen DOOLITTLE</u> born on <u>7 Jan. 1910</u> at <u>Osborne County, Kansas</u> died on <u>10 Jan. 1910</u> at <u>Osborne County, Kansas</u> married _____ at _____ to: _____	Jessie Helen was buried in the Zimmerman cemetery, Osborne County.
	(3) Name <u>Joy (nmn) DOOLITTLE</u> born on <u>11 Oct. 1913</u> at <u>Osborne County, Kansas</u> died on _____ at _____ married <u>19 Dec. 1935</u> at <u>Osborne, Kansas</u> to: <u>Everett B. (Bill) COCHRUN</u> <u>9 July 1907 - 30 Sept. 1979</u>	Children: JoAnn, b. 2 July 1936; Billy Harrison, b. 8 Sept. 1937; Ber- nita Dell, b. 2 Dec. 1938; Benny Kent, b. 11 Sept. 1941; Janet Vee, b. 19 Sept. 1942. All of the above were born at Luray, Kansas. James Mitch- ell, b. 8 Nov. 1945. Russell, KS.

List other children on the reverse side.

Form B-0285

**COCHRUN**

Surname

FAMILY INFORMATION CHART NO. \_\_\_\_\_

Husband's full name Everett B. (Bill) COCHRUN  
 born on 9 July 1907 at Luray, Russell Co., Kansas  
 married 19 Dec. 1935 at Osborne, Kansas  
 died on 30 Sept. 1979 at Downs, Kansas  
 interred at Luray, Kansas, Cemetery . Groom's        marriage  
Farmer                      Methodist  
 Occupation                      Religion                      Military Service

Ben COCHRUN                      Maude CULLINS  
 His Father                      Mother's maiden name

Wife's maiden name Joy (nmn) DOOLITTLE  
 born on 11 Oct 1913 at Osborne County, Kansas  
 died on \_\_\_\_\_ at \_\_\_\_\_  
 interred at \_\_\_\_\_ . Bride's        marriage

Henry H. (Harry) DOOLITTLE      Cardell (nmn) HENSLEY  
 Her Father 1879-1962      Mother's maiden name 1876-1922

Abodes and removals :

Authority or Source of Data:  
 Mrs. Joy Cochrun  
 Box 236  
 Luray, Kansas 67649  
 Courtesy of R. W. Evans  
 =====  
 Records, Census & Others:

Sex	Their Children	Additional Information:
	(1) Name <u>JoAnn COCHRUN</u> born on <u>2 July 1936</u> at <u>Luray, Kansas</u> died on _____ at _____ married <u>14 Aug. 1954</u> at <u>Salina, Kansas</u> to: <u>Larry Lee DENNEY</u> <u>22 Apr. 1935 -</u>	Children: Rhonda Gail, b. 28 Jan. 1957, Roswell, New Mexico; Laurie Ann, b. 27 May 1965, Madrid, Spain; Steven Wayne, b. 8 June 1966, Cheyenne, Wyoming. Larry Lee was born at Mt. Hope, KS. His parents were Cecil & Gladys DENNEY.
	(2) Name <u>Billy Harrison COCHRUN</u> born on <u>8 Sept. 1937</u> at <u>Luray, Kansas</u> died on _____ at _____ married <u>10 Jan. 1960</u> at <u>Russell, Kansas</u> to: <u>Sharon Lee BERGGREN</u> <u>29 July 1938 -</u>	Children: Kendel Gary, b. 21 July 1960, Russell, Kansas; Kari Vae, b. 5 Aug. 1962, Salina, Kansas Sharon Lee was born at Russell, KS. Her parents were Rolland & Marjorie (DAVIS) BERGGREN.
	(3) Name <u>Bernita Dell COCHRUN</u> born on <u>2 Dec. 1938</u> at <u>Luray, Kansas</u> died on _____ at _____ married <u>24 July 1955</u> at <u>Luray, Kansas</u> to: <u>Robert W. CHRISTIANS</u> <u>Feb. 1932 -</u>	Children: Victor Lynn, b. 10 May 1957; Craig Anthony, b. 18 July 1959; Mitchell Brent, b. 19 Apr. 1962; Joel Gregory, b. 1 Mch. 1964. All were born at Hays, Kansas. Robert W. was born at Waldo, KS. to Tony & Alma (SWARTZ-FERGER) CHRISTIANS. <i>Schwerdtfeger</i>

List other children on the reverse side.

Form B-0285

This chart was prepared by Edw<sup>d</sup> Bartlett, 7-18-86.

OVER, PLEASE



Odessa M. Ray  
Route 2, Box 498  
Crescent, Okla. 73028

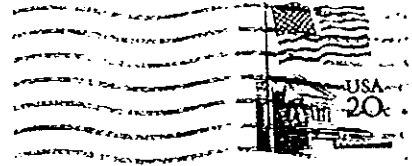

R. W. EVANS  
1111 EARLEY ST.  
SWEENEY, TEXAS 77480

R. W. EVANS  
1111 EARLEY ST.  
SWEENEY, TEXAS 77480

Lot 256

Lot Owner Mary E. Doolittle.

Almon, 1844--1916

Mary E. 1850--1923

Lewis Doolittle Co. C. 11. Kans. Cav. (Cemetery Record Mar. 16, 1919.)

This I have copied from Microfilm # 168-148 Logan Co., News, Aug. 7, 1914 through Dec. 28, 1916.

July 28, 1916.

Almon Doolittle B. Oct. 4, 1844, Licking Co., Ohio. D. July 22, 1916, Crescent, Okla. 71 Yrs. 9 Mo. 18 D. When just a child moved with parents to Crawford Co., Ill. Where he grew up. M. August 1873, Mary Lingafelter. 5 Ch. Oldest dying in infancy. Several years after marriage spent in Kans. 1891 settle on farm near Crescent. Last 8 years spent in Crescent. Surv: Wife, 4 Ch. Margaret, Harry, Nellie and Nettie. Also a Bro. here and Sister in Texas.

*Brief sketch*

Odessa M. Ray  
Sec. & Treasurer of Crescent Cemetery  
association. (we have no section)  
Route 2, Box 498  
Crescent, Okla. 73028

Hope this help you.

Ed - for pursue an obit on Lewis. Do you mind if I send a copy of several of your reports to Old Graves R.W.E.

5. An all year session adapted to local conditions.  
6. A county library with branch libraries at the center of population, with the schools as distributing centers.  
7. Community organization, with the school as the intellectual, industrial, educational and social center.  
8. A modern high-school education for every boy and girl in America, in the country as well as in town.

Hyde Teeter and S. M. Kenyon had an auto collision out by the cemetery, the first of the season. The cars were put out of commission but no one was hurt. A sure pickled out a suggestible place for an accident.  
Commissioner Sloan reports engagements made to have the city line bridge repaired. Bids will be called for at once and the commissions of the two titles will pass upon them. The township line south from the Billing's, a force of colored men have been engaged to grub the road out and it will be graded by the fall. Other repair work, says, is progressing nicely.

R. Hughes and wife arrived yesterday evening last from Springfield, Ill. to visit his sister. Mrs. Cooper of this place, sister, Mrs. Francis Baxter, Columbia. They will also visit Mrs. near Kingfisher before returning to their home. Mr. Hughes is in the utility commission of the State Department and official business to transact Oklahoma City and Tulsa before returning home.

Ed Rose and wife, Mrs. Rose and Mrs. John Ingram, returned from Mayfield, Kan. Saturday, starting about five o'clock and getting here shortly after noon. They came by Boldon and they met Mrs. Bert Powell and daughter and all came in the car together. Mrs. Rose is a sister-in-law of Mrs. Lawrence, and Mrs. Rose and Pardy are cousins of Mrs. Rose.

same color effect. Refreshments were served and everybody had a lovely time. *Logan County News*  
Almon Doolittle.

Almon Doolittle was born Oct. 4, 1844 in Locking, County, Ohio and died July 22, 1916, at Crescent, Okla., aged 71 years, 9 months, 18 days.

When but a child his parents moved to Crawford County, Illinois, where Mr. Doolittle grew to manhood. In August, 1878, he married Mary Lingafelter and to this union were born five children, the eldest dying in infancy. Several years of the married life of Mr. and Mrs. Doolittle were spent in Kansas. In 1891 the family came to Oklahoma and settled on a farm near Crescent. The most of the past twenty-seven years was spent on the farm, but the last eight years the family has resided in Crescent.

Mr. Doolittle was a kind, loving husband and father, his greatest interest and pride being in his family. He was a good friend, one of those quiet, unostentatious men who are content to go about doing good.

His faithful wife and four children, Margaret, Harry, Nellie and Nettie, also a brother here and a sister in Texas survive him and mourn his loss, but it surely must be a comfort and solace to them to know a good man is missing, that his influence for the right will always be remembered in the neighborhoods in which he has lived.

Here was a father whose greatest ambition was to train his children's footsteps in the paths of right, to do good without attracting public notice, to fulfill all his obligations to his family, his neighbors and himself.

The influence of such a man never dies; it is like the flower that blesses us with its purity and fragrance, produces seed and countless other flowers to cheer sad hearts wherever they may be.

Crescent in points.

Mrs. Edgett Stobaug for Colorado stay until it Oklahoma.

Mr. C. O. City, is visit George Wells' father now the Crescent townal

Ern Adair for Amarillo from there parts of Col gone seven Hoyer acc

A. A. Lee John Clari Monday Int in regard to make the N call, and all men.

Homer D tion during has had for probably v Molnes, but his time, will close to O hard, faithl News this vacation and pleasant on

Lost: A charm, a 81 charm. Re and receive:

A sober t official. Th dation that. proval of it Humphrey, County poss tions, theri your sappo Aug. 1st.

Crescent

The follow tions are for cent Storekt rected to T each week. Cora par be

ts  
e  
e

CARD OF THANKS

We wish to extend to kind friends our appreciation for assistance and loving kindness during the burial of our mother Mrs. Mary Doolittle.

Mrs. S. W. Gregory  
Harry Doolittle  
Mrs. Arthur Graves  
Nettie Doolittle.

—We make meat and ice deliveries every morning. Phone 31.—RHOADS & BAKER.

Copy  
Rho

OBITUARY

MRS. MARY DOOLITTLE

Mary Elliott Lingafelter was born in Licking County, Ohio, October 6th, 1850 and died at Harrisonville, Missouri at the home of her daughter, Mrs. Arthur Graves, on May 14, 1923; she being 72 years 7 months and 8 days old. She grew to womanhood near, Casey, Illinois, where on August 24, 1874 she was married to Almon Doolittle. To this union were born five children, one dying in infancy. Those surviving her are; Mrs. Arthur Graves, Harrisonville, Mo., Mrs. G. W. Gregory, Lawton, Oklahoma; Harry Doolittle, Osborne Kansas; and Miss Nettie Doolittle, her husband having preceded her in death on July 22, 1916.

In her early day Mrs. Doolittle united with the Cumberland Presbyterian church and lived a consistent Christian life. Most of her married life was spent at Crescent where Mr. and Mrs. Doolittle resided since 1892. Since the death of her husband she has spent the greater part of her time with her daughters.

Mrs. Doolittle was one of the frontier women of Crescent and will be remembered by the people here as one who did her share in every worthy effort and was loved by old and young. The people of Crescent are deeply grieved over the death of Mrs. Doolittle and wish to join with her children in mourning her departure.

RECIA TION

g  
a  
cc  
m  
te  
fe  
of  
fr  
th  
tal  
lin  
bu  
in  
tw  
to  
th

# THE PASSING OF PIONEER MOTHER

Mrs. Martha Gregory, One of Lewis  
County's Oldest Women, Dies  
in 94th Year.

Mrs. Martha Neal Gregory, daughter of Mr. and Mrs. Thomas Neal, was born at Warrensburg, Kentucky, November 22, 1828, and passed to the Great Beyond July 22, 1921, aged 92 years and 8 months.

Mrs. Gregory was united in the holy bonds of wedlock to Henderson P. Gregory on August 19, 1851. There are six children living as a result of this union. One son, S. W. Gregory, of Devol, Oklahoma, and five daughters, Mrs. Virginia Garnett, of Nowata, Oklahoma; Mrs. Mary Thompson, Mrs. Naunie Hawkins and Misses Linnie and Attie Gregory, of LaBelle.

When Mrs. Gregory was married she and her husband came to Lewis county and settled on a farm north of LaBelle. Later in 1894, they moved to LaBelle, where they lived together until Mr. Gregory's death in the month of October, 1913.

In addition to her immediate family she leaves to mourn her going twelve grandchildren and eighteen grandchildren.

In the going of one who was nearing the century mark, the last of a family of nine children has passed away. Her christian experience dates back to 1838, when she united with the LaBelle Baptist church, remaining a member to her death. She is one of the pioneers of Missouri and has had a large part in its development. She has witnessed a great change in the seventy years of her life among us. A pioneer has passed on.

On August 19, 1901, the family celebrated their golden wedding anniversary, but she has lived on and still lives on in our lives and the lives of the sorrowing ones. May the memory of her life and the joy of her worthy companionship blossom into a full grown flower of sacred memory in our lives.

Those from out of town who attended the funeral were S. W. Gregory, Devol, Oklahoma; Mrs. S. V. Garnett, Nowata, Oklahoma; Mrs. Mattie Gregory and daughter, Lula, and son, Shelton, of Kirksville; Ed Keithly and wife, of Center, Missouri; J. B. Gregory and wife and daughter, Lydia, of Memphis; Mrs. Arthur Meadows, of Quincy; Elmer True and wife, of Newark, and Frank McRae and wife, of Knox City. \* \* \*

tenant and A. D. Otey, second lieutenant. We have no record of its operations during its term of service.

The One Hundred and Fifty-second Infantry recruited under the call for "one year service," contained a Crawford County company. Company H went into the field in charge of the following commissioned officers: George W. Beam, captain; William Dyer, first lieutenant; Ferdinand Hughes, second lieutenant.

The One Hundred and Fifty-second was recruited for one year, and was organized at Camp Butler, Illinois, February 18, 1865. It went to Nashville, and thence to Tullahoma. It was mustered out of the service September 11, 1865, at Camp Butler.

The One Hundred and Fifty-fifth Infantry drew a company from Crawford County. Company C was principally from this county, and had the following commissioned officers: John W. Lowber, captain; Ross Neeley, first lieutenant, and Marshall C. Wood, second lieutenant.

This regiment was organized at Camp Butler, Illinois, February 28, 1865, for one year. March 2d, the regiment, 904 strong, proceeded via Louisville and Nashville to Tullahoma, where it was employed mostly in guard duty on the Nashville & Chattanooga Railroad. September 4, 1865, it was mustered out of the service at Camp Butler and discharged.

The Fifth Illinois Cavalry contained a Crawford County company of men. Company F was principally from this county, and was officered as follows: Horace P. Mumford, captain; Francis M. Dorothy, first lieutenant, and Wm. Wagenseller, second lieutenant. Capt. Mumford was promoted to major of the regiment May 24, 1863, and died October 26, 1864, at Springfield, Ill. Lieut. Dorothy resigned January 10, 1863; Lieut. Wagenseller was promoted to first lieutenant January 10, 1863, and to captain May 24,

1863, and then resigned. Thos. J. Dean came second lieutenant, was promoted to lieutenant May 24, 1863, to captain July 1864, and died on the 20th of September following. James H. Wood became second lieutenant May 24, 1863, was promoted first lieutenant July 5, 1864, to captain September 20, 1864, and was mustered out of the regiment at the close of the war. Edw. P. Martin was promoted to second lieutenant then became adjutant and afterward resigned. Jacob Stifal was made first lieutenant, remained in the service until the muster out of the regiment; James G. Bennett was promoted to second lieutenant October 26, 1864, but mustered out as sergeant.

Of the field and staff, Major Mumford, Adjutant Martin, Quartermaster Robert Wilson, and Surgeon Wm. Watts, were Crawford County men. Adjutant Martin resigned, Quartermaster Wilson was mustered out of the service. Dr. Watts entered as assistant surgeon, was promoted to surgeon and was mustered out October 27, 1865, with the regiment.

Maj. Mumford died in the latter part of 1864. The following tribute to his gallantry as a soldier and officer, was paid him by Gen. Dennis, in a letter to Hon. Jesse K. Dubois: "This will be handed you by Maj. Mumford of the Fifth Illinois Cavalry Volunteers. The Major has been in my command for the last few months, and the greater portion in command of his regiment. In the expedition for Vicksburg, the Major had command of the entire cavalry forces, composed of parts of four regiments. When I say that he handled his command as well, and did better fighting than any cavalry officer I have met with in Mississippi, it will be indorsed by all the officers who were with the late raids. Major Gen. Slocum was so well pleased and satisfied with him and the good discipline of his men, that he continued him in command, and

1850 CENSUS — UNITED STATES

SCHEDULE 1. Free Inhabitants in (Not recorded) 1. \_\_\_\_\_, in the County of \_\_\_\_\_, State \_\_\_\_\_  
of ILLINOIS, enumerated by me on the 27<sup>th</sup> day of August, 1850. \_\_\_\_\_, Ass't Marshal

Line No. on page	Dwellings House No.	Family Number	The name of every person whose usual place of abode on the first day of June, 1850, was in this family.	Age	Sex	Color	Profession, Occupation, or Trade of each male person over 15 years of age.	Value of Real Estate owned	Place of birth	Married within the year	Attended School within the year	Over 20 who can not read & write	Whether deaf & dumb, blind, insane, idiotic, pauper or convict.	(Remarks)	
10	119	119	Tartus M. WARD	34	m	n/r	Farmer	1200	Ohio					Married 14 Mch. 1839, Licking Co., Ohio to Elvira M. Doolittle.	
11			Alvina WARD	30	f				N York		n/r				
12			William J. "	9	m				Ohio		/				
13			Elias P. "	6	m				"		/				
14			Josiah W. "	2	m				Illinois		/				
15			Melissa J. RIDENOUR	7	f				Ohio		/				
16			Thomas LEWIS	24	m		Farmer		Pennsylvania						
33	122	122	Josiah S. WARD	32	m		Farmer	1500	Ohio					Married 21 Feb. 1839, Licking Co., Ohio to Mary M. Burner	
34			Mary M. WARD	30	f				"						
35			Rebecca E. "	10	f				"		/				
36			Elias S. "	9	m				"		/				
37			Sarah C. "	6	f				"		/				
38			Jonas H. "	4	m				Illinois						
39			Isaac M. "	1/3	m				"						
			This is page 1 of 2												
			n/r = not recorded												

1850 CENSUS — UNITED STATES

SCHEDULE 1. Free Inhabitants in \_\_\_\_\_ (Not recorded) \_\_\_\_\_, in the County of \_\_\_\_\_, State \_\_\_\_\_  
 of ILLINOIS, enumerated by me on the 27th day of August, 1850. \_\_\_\_\_ G. W. Smith Ass't Marshal

Line No. on page	Dwelling house No.	Family Number	The name of every person whose usual place of abode on the first day of June, 1850, was in this family.	Age	Sex	Color	Profession, Occupation, or Trade of each male person over 15 years of age.	Value or Real Estate owned	Place of birth	Married within the year	Attended School within the year	Over 20 who cannot read & write	Whether deaf & dumb, blind, insane, idiotic, pauper or convict.	(Remarks)	
40	123	123	Jonas WARD	60	m		Farmer	(n/r)	Virginia					Married 22 Sept. 1814, Licking Co., Ohio to Elizabeth DeWeese.	
41			Elizabeth WARD	55	f				Ohio						
42			Elias C. "	25	m		Farmer	1600	"						
1			Jerusha WARD	10	f				Ohio	/					
32	128	128	Gasway H. SELBY	38	m		Stone cutter	(n/r)	Maryland					Married 1839, Delaware Co., Ohio to Margaret Bockover	
33			Margaret SELBY	27	f				N Jersey						
34			Thomas J. "	10	m				Ohio	/					
35			Isaac N. "	8	m				"	/					
36			Abigail L. "	6	f				"	/					
37			Sarah F. "	1	f				Illinois						
38			Jonas L. WARD	28	m		Cabinet maker	(n/r)	Ohio					Married 3 Mch. 1853, Crawford Co. Ills. to Widow Margaret Selby.	
			This is page 2 of 2.												









INFORMATION & DATA ON THE FAMILY OF:

VARNAL & HANNAH DOOLITTLE  
1814- 1818-1850

---

Being a collection of information from Public records, biographies, histories and family sources, and arranged to present a coherent view of said family and their individual relationship. This has all been done for the purpose of preserving for future generations a knowledge of their past.

Date 18 July 1986

*Edward E. Bartlett*, Compiler

MID-CONTINENT PUBLIC LIBRARY  
NORTH INDEPENDENCE BRANCH  
GENEALOGY DEPT.

## MARLING

Surname

FAMILY INFORMATION CHART NO. \_\_\_\_\_

Husband's full name Samuel Thomas MARLING  
 born on 30 May 1840 at Marion County, Ohio  
 married 3 Sept. 1861 at Washington County, Iowa<sup>1</sup>  
 died on 25 Dec. 1925 at East Bernard, Texas  
 interred at E. Bernard Methodist Cem.. Groom's 1st marriage  
Farmer 7th Day Adventist Co.'G', 22nd Iowa Vol Inf  
 Occupation Religion Military Service  
John MARLING Hannah C. WARDEN  
 His Father Mother's maiden name

Authority or Source of Data:

Robert W. Evans  
 401 Bellaire  
 Waco, Texas 76710 (1986)

Records, Census &amp; Others:

1. Washington Co., IA, Marriage  
 Records, Book E, page 9.

Wife's maiden name Alvira DOOLITTLE  
 born on 4 Sept. 1842 at Licking County, Ohio  
 died on 14 May 1926 at \_\_\_\_\_  
 interred at E. Bernard Methodist Cem.. Bride's 1st marriage  
Varnal DOOLITTLE Hannah  
 Her Father Mother's maiden name

Abodes and removals :

Sex	Their Children	Additional Information:
	(1) Name <u>Milton LeRoy MARLING</u> born on <u>22 Aug. 1862</u> at <u>Washington County, Iowa</u> died on <u>17 Dec. 1937</u> at <u>East Bernard, Texas</u> married <u>21 Sept. 1889</u> at <u>Winfield, Cowley Co., KS</u> to: <u>Dora Elizabeth GRAHAM</u>	
	(2) Name <u>Alvin Josiah MARLING</u> born on <u>27 Nov. 1867</u> at <u>Sarcoxie, Jasper Co., MO</u> died on <u>22 Aug. 1945</u> at <u>Ralston, Oklahoma</u> married <u>9 Apr. 1892</u> at <u>New Salem, Cowley Co., KS</u> to: <u>Ruth Ellen GRAHAM</u>	
	(3) Name <u>Lewis Edward MARLING</u> born on <u>23 Feb. 1870</u> at <u>Sarcoxie, Jasper Co., MO</u> died on <u>29 Sept. 1949</u> at <u>Santa Barbara, California</u> married <u>1893</u> at <u>Winfield, Kansas</u> to: <u>#1. Mabel Lee TOMLINSON</u>	

List other children on the reverse side.

Prepared by Edw.<sup>d</sup> Bartlett, 7-19-86

Form B-0285

OVER, PLEASE

CHILDREN OF Samuel Thomas and Alvira (DOOLITTLE) MARLING

Sex

( 4 ) Name Charles Franklin MARLING  
 born on 16 Mch. 1872 at \_\_\_\_\_  
 died on 14 Sept. 1873 at Jasper County, Missouri  
 married \_\_\_\_\_ at \_\_\_\_\_  
 to: \_\_\_\_\_

( 5 ) Name Florence Alvira MARLING  
 born on 14 June 1874 at Riverside, Iowa  
 died on 3 Aug. 1944 at Chesterfield, Texas  
 married 26 Mch. 1898 at Hemphill County, Texas  
 to: John Wesley MARLING

( ) Name \_\_\_\_\_  
 born on \_\_\_\_\_ at \_\_\_\_\_  
 died on \_\_\_\_\_ at \_\_\_\_\_  
 married \_\_\_\_\_ at \_\_\_\_\_  
 to: \_\_\_\_\_

( ) Name \_\_\_\_\_  
 born on \_\_\_\_\_ at \_\_\_\_\_  
 died on \_\_\_\_\_ at \_\_\_\_\_  
 married \_\_\_\_\_ at \_\_\_\_\_  
 to: \_\_\_\_\_

( ) Name \_\_\_\_\_  
 born on \_\_\_\_\_ at \_\_\_\_\_  
 died on \_\_\_\_\_ at \_\_\_\_\_  
 married \_\_\_\_\_ at \_\_\_\_\_  
 to: \_\_\_\_\_

( ) Name \_\_\_\_\_  
 born on \_\_\_\_\_ at \_\_\_\_\_  
 died on \_\_\_\_\_ at \_\_\_\_\_  
 married \_\_\_\_\_ at \_\_\_\_\_  
 to: \_\_\_\_\_

Use this side of another of these forms if there are more than nine children.

INFORMATION & DATA ON THE FAMILY OF:

VARNAL & HANNAH DOOLITTLE

1814-

1818-1850

---

Being a collection of information from Public records, biographies, histories and family sources, and arranged to present a coherent view of said family and their individual relationship. This has all been done for the purpose of preserving for future generations a knowledge of their past.

Date 18 July 1986

*Edward E. Bartlett*, Compiler

MID-CONTINENT PUBLIC LIBRARY  
NORTH INDEPENDENCE BRANCH  
GENEALOGY DEPT.

DOOLITTLE  
Surname  
FAMILY INFORMATION CHART NO.

Husband's full name Almon DOOLITTLE  
 born at Licking County, Ohio on 4 Oct. 1844  
 married at Crawford Co., Illinois on 31 Aug. 1873 (1)  
 died at Logan Co., Oklahoma on 22 July 1916  
 interred at \_\_\_\_\_ No. Groom's marriages 1

Farmer  
 Occupation \_\_\_\_\_ Religion \_\_\_\_\_ Military Service \_\_\_\_\_  
Varnal DOOLITTLE \_\_\_\_\_ Hannah  
 His Father \_\_\_\_\_ Mother's maiden name \_\_\_\_\_

Wife's maiden name Mary Elliott LINGAFELTER  
 born at Licking County, Ohio on 6 Oct. 1850  
 died at Harrisonville, Missouri on 14 May 1923  
 interred at \_\_\_\_\_ No. Bride's marriages 1

Cumberland Presbyterian  
 Occupation \_\_\_\_\_ Religion \_\_\_\_\_  
William LINGAFELTER \_\_\_\_\_ Margaret RILEY  
 Her Father \_\_\_\_\_ Mother's maiden name \_\_\_\_\_

Abodes and removals: Came from Ohio with parents in 1848 to  
 Crawford Co., Ills.. Came to Cowley Co., Kansas in 1883. In  
 1891 left to homestead in Logan Co., Oklahoma.

Authority or source of information:  
 Mrs. James A. Graves, II (Ola)  
 P. O. Box 263  
 Shell Knob, MO 65747

Records, Census & Others:  
 (1) Crawford Co. Marriage Record "B", page 301  
 Dr. Arthur Graves & wife, Nellie's obituaries in the Cass County Democrat - Missourian, Harrisonville, MO

Sex	Children	Additional information
	(1) Name <u>Charles DOOLITTLE (2)</u> born at <u>Crawford Co., Ills.</u> on <u>18 Sept. 1875</u> died at <u>Crawford Co., Ills.</u> on <u>20 Sept. 1875</u> married at _____ on _____ to _____	(2) Charly is buried in the Belaire, Ills. Cemetery. The date of his death is from his gravestone and gives his age as 2 days.
	(2) Name <u>Margaret D. DOOLITTLE (3)</u> born at <u>Crawford Co., Ills.</u> on <u>28 Mar. 1878*</u> died at <u>Durant, Oklahoma</u> on <u>16 Mar. 1969</u> married at _____ on _____ to <u>W. S. GREGORY (4)</u>	(3) Was Supt. of Public Education, Logan Co., Guthrie, Okla., 1919 - per letter to S.T. Marling, E. Bernard, TX (4) Taught govt. in college in Durant, OK, until his death.
	(3) Name <u>Henry Harrison (Harry) DOOLITTLE</u> born at <u>Crawford Co., Ills.</u> on <u>25 Sept. 1879</u> died at <u>Osborne, Kansas</u> on <u>31 Dec. 1962</u> married at <u>Osborne, Kansas</u> on <u>25 May 1902</u> to <u>Cardell (NMN) HENSLEY</u> b. 22 Aug. 1876 - d. 29 June 1922	Children 1. Harry Alvey DOOLITTLE b. 2 Feb. 1908, Osborne Co. 2. Jessie Helen DOOLITTLE b. 7 Jan. 1910, Osborne Co. 3. Joy (nmn) DOOLITTLE b. 11 Oct. 1913, Osborne Co.
	(4) Name <u>Nellie Mae DOOLITTLE</u> born at <u>Crawford Co., Ills.</u> on <u>8 June 1882 (6)</u> died at <u>Harrisonville, MO</u> on <u>17 Sept. 1971</u> married at <u>Oklahoma City, OK</u> on <u>28 May 1908</u> to <u>Dr. James Arthur GRAVES (7)</u> List other children on the reverse side.	Had one son: Arthur Jean GRAVES b. 1 Feb. 1919 w. Kansas City, Missouri (6) Birth Records, Vol. 1, pg. 182. (7) b. 3/29/1883, Shenandoah, IA d. 8/15/1973, Harrisonville, MO

Other information & sources: \* Funeral record gives Margaret's date of birth as Mar. 28, 1882, age 86 but the 1880 Fed Census has recorded her as being 2 yrs. old. Form B-0280  
 Thus she was about 91 at time of death. Rev. 1, 2-3-84

Sex	<p>(5) Name <u>Nettie Alice DOOLITTLE (7)</u>                      born at <u>Cowley Co., Kans.</u> on <u>6 May 1885</u>                      died at <u>Durant, Oklahoma</u> on <u>14 May 1920</u>                      married at <u>Never married</u> on _____                      to _____</p>	<p>(7) Taught at University of Missouri and retired in Durant, OK</p>
	<p>(6) Name _____                      born at _____ on _____                      died at _____ on _____                      married at _____ on _____                      to _____</p>	
	<p>(7) Name _____                      born at _____ on _____                      died at _____ on _____                      married at _____ on _____                      to _____</p>	
	<p>(8) Name _____                      born at _____ on _____                      died at _____ on _____                      married at _____ on _____                      to _____</p>	
	<p>(9) Name _____                      born at _____ on _____                      died at _____ on _____                      married at _____ on _____                      to _____</p>	
	<p>(10) Name _____                      born at _____ on _____                      died at _____ on _____                      married at _____ on _____                      to _____</p>	
	<p>(11) Name _____                      born at _____ on _____                      died at _____ on _____                      married at _____ on _____                      to _____</p>	
	<p>(12) Name _____                      born at _____ on _____                      died at _____ on _____                      married at _____ on _____                      to _____</p>	

Continue on another form if there are more children.



COCHRUN

Surname

FAMILY INFORMATION CHART NO. \_\_\_\_\_

Husband's full name Everett B. (Bill) COCHRUN  
 born on 9 July 1907 at Luray, Russell Co., Kansas  
 married 19 Dec. 1935 at Osborne, Kansas  
 died on 30 Sept. 1979 at Downs, Kansas  
 interred at Luray, Kansas, Cemetery . Groom's \_\_\_\_\_ marriage  
Farmer                      Methodist  
 Occupation                      Religion                      Military Service

Ben COCHRUN                      Maude CULLINS  
 His Father                      Mother's maiden name

Wife's maiden name Joy (nmn) DOOLITTLE  
 born on 11 Oct 1913 at Osborne County, Kansas  
 died on \_\_\_\_\_ at \_\_\_\_\_  
 interred at \_\_\_\_\_ . Bride's \_\_\_\_\_ marriage

Henry H. (Harry) DOOLITTLE      Cardell (nmn) HENSLEY  
 Her Father 1879-1962      Mother's maiden name 1876-1922

Authority or Source of Data:

Mrs. Joy Cochrun  
 Box 236  
 Luray, Kansas 67649  
 Courtesy of R. W. Evans

Records, Census & Others:

Abodes and removals :

Sex	Their Children	Additional Information:
	(1) Name <u>JoAnn COCHRUN</u> born on <u>2 July 1936</u> at <u>Luray, Kansas</u> died on _____ at _____ married <u>14 Aug. 1954</u> at <u>Salina, Kansas</u> to: <u>Larry Lee DENNEY</u> <u>22 Apr. 1935 -</u>	Children: Rhonda Gail, b. 28 Jan. 1957, Roswell, New Mexico; Laurie Ann, b. 27 May 1965, Madrid, Spain; Steven Wayne, b. 8 June 1966, Cheyenne, Wyoming. Larry Lee was born at Mt. Hope, KS. His parents were Cecil & Gladys DENNEY.
	(2) Name <u>Billy Harrison COCHRUN</u> born on <u>8 Sept. 1937</u> at <u>Luray, Kansas</u> died on _____ at _____ married <u>10 Jan. 1960</u> at <u>Russell, Kansas</u> to: <u>Sharon Lee BERGGREN</u> <u>29 July 1938 -</u>	Children: Kendel Gary, b. 21 July 1960, Russell, Kansas; Kari Vae, b. 5 Aug. 1962, Salina, Kansas  Sharon Lee was born at Russell, KS. Her parents were Rolland & Marjorie (DAVIS) BERGGREN.
	(3) Name <u>Bernita Dell COCHRUN</u> born on <u>2 Dec. 1938</u> at <u>Luray, Kansas</u> died on _____ at _____ married <u>24 July 1955</u> at <u>Luray, Kansas</u> to: <u>Robert W. CHRISTIANS</u> <u>Feb. 1932 -</u>	Children: Victor Lynn, b. 10 May 1957; Craig Anthony, b. 18 July 1959; Mitchell Brent, b. 19 Apr. 1962; Joel Gregory, b. 1 Moh. 1964. All were born at Hays, Kansas. Robert W. was born at Waldo, KS. to Tony & Alma (SWARTZFERGER) CHRISTIANS. <i>Schwerdtfeger</i>

List other children on the reverse side.

Form B-0285

CHILDREN OF Everett B. (Bill) and Joy (DOOLITTLE) COCHRUN

Sex ( 4 ) Name Benny Kent COCHRUN  
 born on 11 Sept. 1941 at Luray, Kansas  
 died on 19 Aug. 1969 at Boardman Bombing Range<sup>1.</sup>  
 married 4 Mch. 1965 at Topeka, Kansas  
 to: Julia RANDELLS  
8 Nov. 1942 -

They had no children.  
 Julia was born at Bluff City, KS.  
 to W. I. & Buelah Randells.  
 1. in Oregon.

( 5 ) Name Janet Vee COCHRUN  
 born on 19 Sept. 1942 at Luray, Kansas  
 died on \_\_\_\_\_ at \_\_\_\_\_  
 married 4 Nov. 1962 at Salina, Kansas  
 to: Hobart C. (Jim) MOODY  
15 Aug. 1936 -

Children:  
 Van Loren, b. 7 Feb. 1964,  
 Salina, Kansas  
 Wesley Alan, b. 22 Dec. 1966,  
 Plattsburg, New York.  
 Mr. Moody was born at Dayton, OH

( 6 ) Name James Mitchell COCHRUN  
 born on 8 Nov. 1945 at Russell, Kansas  
 died on 25 Feb. 1968 at Lucas, Kansas  
 married \_\_\_\_\_ at \_\_\_\_\_  
 to: \_\_\_\_\_

James died in a car accident and  
 is buried at Luray, Kansas. He  
 was not married.

( ) Name \_\_\_\_\_  
 born on \_\_\_\_\_ at \_\_\_\_\_  
 died on \_\_\_\_\_ at \_\_\_\_\_  
 married \_\_\_\_\_ at \_\_\_\_\_  
 to: \_\_\_\_\_

( ) Name \_\_\_\_\_  
 born on \_\_\_\_\_ at \_\_\_\_\_  
 died on \_\_\_\_\_ at \_\_\_\_\_  
 married \_\_\_\_\_ at \_\_\_\_\_  
 to: \_\_\_\_\_

( ) Name \_\_\_\_\_  
 born on \_\_\_\_\_ at \_\_\_\_\_  
 died on \_\_\_\_\_ at \_\_\_\_\_  
 married \_\_\_\_\_ at \_\_\_\_\_  
 to: \_\_\_\_\_

Use this side of another of these forms if there are more than nine children.

**GRAVES**

Surname

FAMILY INFORMATION CHART NO. \_\_\_\_\_

Husband's full name James Arthur GRAVES, DVM  
 born on 29 Mch. 1883 at Shenandoah, Page County, Iowa  
 married 28 May 1908 at Oklahoma City, Oklahoma  
 died on 15 Aug. 1973 at Harrisonville, Cass Co., MO

Authority/Source of Data:

Ola M. Graves  
 P. O. Box 263  
 Shell Knob, MO 65747

Interred at Orient Cemetery Groom's 1<sup>st</sup> marriage  
 Dr. Vet'y Med. Methodist none  
 Occupation Religion Military Service

Records, Census & Others:

Albert S. GRAVES 1. Rhoda GRIEST  
 His Father Mother's maiden name

Wife's maiden name Nellie Mae DOOLITTLE  
 born on 7 June 1883 at Crawford County, Illinois  
 died on 17 Sept. 1971 at Harrisonville, Missouri  
 Interred at Orient Cemetery Bride's 1<sup>st</sup> marriage  
Almon DOOLITTLE Mary LINGAFELTER  
 Her Father 1844-1916: Mother's maiden name 1850-1923

Abodes and removals:

Sex

Their Children

Additional Information:

(1) Name Arthur Jean GRAVES  
 born on 1 Feb. 1919 at Kansas City, Missouri  
 died on \_\_\_\_\_ at \_\_\_\_\_  
 married 15 June 1946 at Yuma, Yuma Co., Arizona  
 to: Edith Caroline PRATT  
1919 - 19 Sept. 1960

Children:  
 1. James Arthur GRAVES II <sup>2.</sup>  
 b. 4 Dec. 1947  
 w. Monett, Missouri  
 2. Alfred Guy GRAVES  
 b. 3 June 1951  
 d. 3 June 1951

(2) Name \_\_\_\_\_  
 born on \_\_\_\_\_ at \_\_\_\_\_  
 died on \_\_\_\_\_ at \_\_\_\_\_  
 married \_\_\_\_\_ at \_\_\_\_\_  
 to: \_\_\_\_\_

(3) Name \_\_\_\_\_  
 born on \_\_\_\_\_ at \_\_\_\_\_  
 died on \_\_\_\_\_ at \_\_\_\_\_  
 married \_\_\_\_\_ at \_\_\_\_\_  
 to: \_\_\_\_\_

Prepared by  
 Edw<sup>d</sup> Bartlett, 01-19-88

1. & 2. see other side for footnotes.

## FOOTNOTES

1. Albert S. GRAVES was born 21 June 1840 in Montgomery County, Indiana. His parents were Quakers and he followed the faith all his life but was not connected with any church after moving to Iowa. On 3 October 1872 he married Rhoda GRIEST and in the same year they moved to Fremont County, Iowa. Rhoda was a member of the Friends Church there. In Fremont county they owned a two hundred acre farm. He was successful at farming and was a director of a savings bank. He gained his wealth by his own right.

Their sons were Omer E., William P., Albert M., and James Arthur. Their father Albert S., one of the oldest settlers in Fremont County, died at home eight miles northwest of Shenandoah, Iowa, in Monroe Township, at the age of 64 yrs. and 9 mos., the date 18 April 1905. His wife Rhoda died at the home of her son, Albert M.. She and her husband are buried in the cemetery in Shenandoah, Iowa. All the sons are now deceased.

2. James Arthur GRAVES II. His parents was Arthur Jean and Edith Caroline (PRATT) GRAVES. His mother was a daughter of Charles E. and Mabel PRATT of Newton Highlands, Massachusetts. She had graduated from Colby College in New London, New Hampshire, and was a medical secretary at the Elliot P. Joslin Clinic in Boston when she met and married Arthur Jean GRAVES in Yuma, Arizona, 5 June 1946, while he was stationed in the U.S. Marine Corp Base in San Diego.

Arthur Jean GRAVES graduated from high school at Harrisonville, Missouri, in 1935. He worked for Gulf Oil Company in the chemistry laboratory for salt water analysis during the summer of 1937 thru 1939, before going to Central College in Fayette, Missouri. After graduating from college he went to Harvard Medical School and received his M.D. degree. He interned at St. Lukes in New York.

He entered the Navy with the rank of Lt. Junior Grade and served 32 months in the Pacific as a medical officer and participated in the invasion of Okinawa and Japan. His wife, Edith, died 19 September 1960 and is buried in the Orient Cemetery, Harrisonville, Missouri. He is now retired and resides in Mt. Vernon, Missouri.

James Arthur "Butch" GRAVES II was born 4 December 1947 at Monett, Missouri, has since 1976 lived in Shell Knob, Missouri. He married Ola May CONNER on 28 July 1973 after they had met in Chicago, Illinois. Ola had moved to Chicago from Birmingham, Alabama. She was born 19 November 1947 in Pickens County, Alabama. They had only one child, a daughter, Amanda June GRAVES, born 27 June 1977 and died 29 June 1977.

From information compiled at Christmas time  
1983 by Ola, Butch, and Arthur J. GRAVES

e.e.b.